



LOFRANS 2016/2017

FÜR WASSERSPORTLER, DIE KEINE KOMPROMISSE EINGEHEN

Lofrans' Now

The intensive research of new anchoring solutions having the ability to operate in the marine environment, has led us to build up a strong relationship with a group of carefully selected suppliers, whose long term co-operation has helped us in the construction of the components for our anchor windlasses.

This synergy gave us the ability to produce top level products in terms of quality and performance. We have been rewarded by the market which considers us the leader of this product.



With the latest CATIA CAD software, our engineers are constantly developing ideas and innovative solutions with regards to product evolution. The integration of these designs to our CAM system ensures that the switch from a conceptual idea to the actual produced component is achieved in a flawless manner.

Being one of the most weatherbeaten and mechanically challenged equipment on the deck, a windlass could not stand anything else than premium materials. Our products utilize only specific marine materials, able to withstand marine corrosion and treated in such way so as to increase their mechanical strength.



At Lofrans, we believe that durability and performance start with an extremely stringent selection of components: only AISI 316 L stainless steel, marine grade metals and electric motors designed to deliver high torque in all conditions.

Most of our components are produced by hot pressing, a technology which guarantees minimal porosity in the metal and superior mechanical features.

The most exposed components are then chemically treated in order to slow down and minimize the process of marine corrosion.

Today our anchor windlasses and capstans are able to cover the needs for vessels with a length from 6 up to 50 meters, from a range consisting of more than 25 different models.

The production is carried out in our 5000 sqm factory in Monza, where our team of designers, technicians and qualified employees are located together with our finished stock and spare parts warehouse.

During the production process in our factory, we carry out several dimensional tests on components and final products by use of our 3D co-ordinate measuring machine, as well as marine corrosion tests in a special marine environment chamber, which simulates the harshest of marine environments.

Our products meet the requirements of the most important classification societies such as RINA, BV, DNV and several others.

An important part of the Lofrans' organization is the sales and the service, which are guaranteed through a worldwide network of more than forty official distributors in the most important marine markets.

The success of Lofrans products is testified by the fact that our products are installed as standard on vessels of the most important and well reputed OEMs globally.

Since the beginning of 2013, great amounts have been invested to ensure that longevity, evolution, quality and control are guaranteed for the further development of Lofrans'. Major investments included the installation of the SAP ERP, the installation of a WMS (Warehouse Management System) integrated with hand held scanner order picking, additional Product Quality Assurance systems and Distributor order automation via an in-house B2B ordering tool.



Why is it necessary to install an anchor windlass?

There are two main reasons: Safety and Utility. The anchor windlass on your vessel allows you to handle different anchoring situations, even the most critical, always under complete safety. Every anchoring operation will be extremely simple, fast and firm under your control. No more fear of failing to recover your anchor and every anchoring will be a pleasure. No more heavy and complicated operations. Installing an anchor windlass means making an investment on the safety of your crew and your vessel.

And what about a capstan?

Capstans are normally installed on the stern of the boat for mooring maneuvers. They are equally suitable for recreational boats, fishing and commercial vessels. One or two capstans -depending on boat size and displacement- are installed on the boat in conjunction with an anchor windlass. Capstans are monitored by a set of foot switches, leaving your hands free for rope handling. The range of Lofrans capstans is designed for boats from 6 to 45 m (18 to 150').

Why choose a Lofrans' anchor windlass?

The strong point of every successful manufacturer is the quality, the reliability and the support they provide for their products.

- Does the product work properly as was stated by the manufacturer?
- Is the product worth the price paid for it?
- Is the product still reliable after years of use?
- Is there a reliable after sales support organization, able to directly respond to end-user requests from anywhere around the world?

If the product is a Lofrans', the answer to these questions is definitely YES.

We do not say this by ourselves, but it is said by the thousands and thousands of our satisfied customers all over the world who chose our products, making Lofrans' today the most popular manufacturer of anchor windlasses.

This important result is more than anything a testimony of the quality of our product and the great reputation of the Lofrans' brand globally.

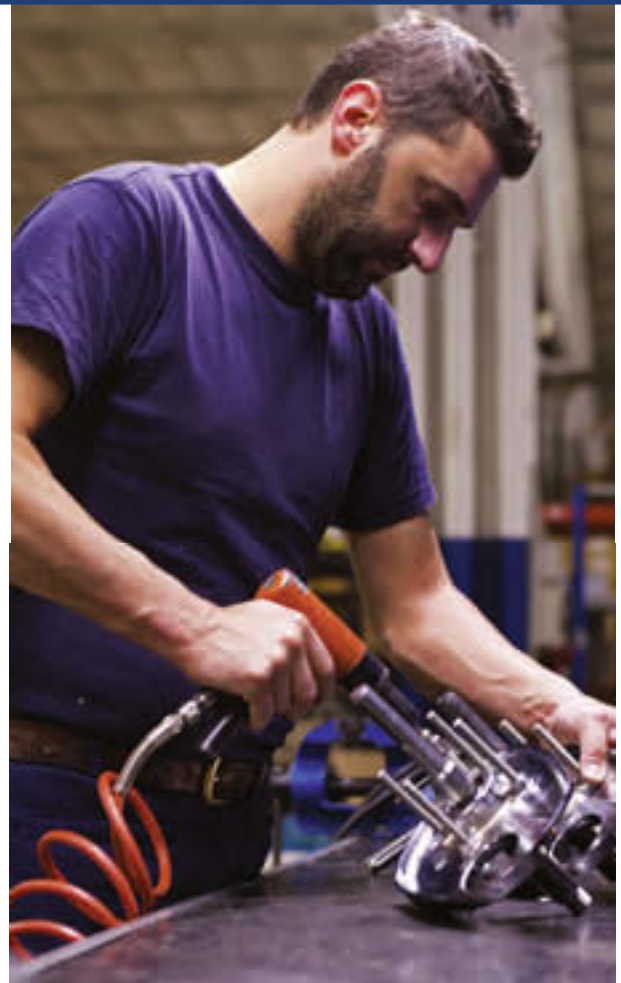

Lofrans!®

WINDLASSES

THE ORIGINAL WINDLASS

We have been making
boating safer & easier
since 1966



We have revived & reinvented
customer satisfaction
since 2013

Easy web ordering &
next day dispatch of spare parts



Global Network



**Fast worldwide
delivery 5 main
logistics hubs:**

- USA
- Dubai
- Belgium
- Greece
- Italy

INNOVATIONS

WHY CHOOSE LOFRANS



Warum Ankerwinden von Lofrans' ?

Der namhafte Italienische Windenhersteller Lofrans' produziert seit nunmehr 35 Jahren Ankerwinden für Schiffe und Yachten bis zu 40 Metern Länge. Von Anfang an waren die Ziele die alleinige Konstruktion und Herstellung qualitativ hochwertiger Ankerwinden für die Sportschiffahrt und Berufsschiffahrt.

Die technischen Komponenten sind exakt aufeinander abgestimmt und Sie dürfen sicher sein, mit einem Lofrans Produkt ein Höchstmaß an Perfektion und Zuverlässigkeit zu erwerben. Weiterhin steht Lofrans' für Winden mit optimalem Wirkungsgrad und das bei stets IP 56 wassergeschützten Motoren.

Was ist das geeignete Modell für mein Schiff?

So oder ähnlich lautet die meist gestellte Frage. Zunächst einmal unterscheiden wir zwischen elektrischen und manuellen Winden.

Manuelle Winden werden meist dort eingebaut, wo es um eine preiswerte Winde geht, die ohne elektrische Verkabelung sofort einsatzbereit ist.

Elektrische Winden stehen für eine komfortable Lösung an Bord. Durch das Bordstrom-netz wird entweder mit 12 Volt oder 24 Volt die Energiezufuhr hergestellt. Mittels Bedienelement können Sie bequem das Ankermanöver einleiten oder aber elektrisch den Anker hieven.

Daneben sind auch Modelle erhältlich bei denen Sie wahlweise Kette oder Tauwerk bewegen können.

Schließlich gibt es Ankerwinden, die zusätzlich neben der Kettenuß noch über ein Verholspill verfügt; dies erleichtert das Verholen von Schiffen sehr! Abschließend muß angefügt werden, daß Lofrans' Ankerwinden gleichermaßen für den Einsatz auf Motor- als auch auf Segelbooten konzipiert sind!

Über die Technik kann gesagt werden,

daß Lofrans' einen idealen Mix aus optimalen Materialkomponenten bei geringem Gewicht, bei hoher Festigkeit und Korrosionsbeständigkeit anzubieten hat.

Spezielle Veredelungsverfahren der Oberfläche durch chemische und galvanische Vergütungsprozesse imponieren unserem Hause als dem bekannten Hersteller von Aluminium-Bootsbeschlägen besonders!

Vertikale oder Horizontale Winde?

Schiffsindividuelle Lösungen bietet hier auch Lofrans' an!

Vertikale Lösungen haben den Vorteil, daß sie sehr klein und kompakt ausfallen. Der Motor und das Getriebe werden unter Deck montiert. Unschlagbar auch das geringe Gewicht bei einem sehr positiven Preis- Leistungsverhältnis.

Die klassischen Ankerwinden sind über Deck montiert und diese verfügen über einen horizontalen Antrieb. Gleichwohl bauen heute viele Werften auch diese Typen in den Anker-kasten ein.

Ein stabiles Gehäuse schützt dabei den Elektromotor, das Getriebe und die mechanischen Teile gegen Umwelteinflüsse.

Designing and making windlasses for more than 40 years leads us to experience a lot about our product which has been having a constant evolution year by year. We fully understood that to give a real quality to our product means to take care about all the details because they often make the difference. Quality for us is:

In Lofrans we look at the quality in two directions:

- *The quality that comes from the perception of the product the end user which lead us to design and build a smooth product.*
- *The quality in terms of reliability and performances which lead us to think about a product able to withstand the extreme marine conditions.*

Since the beginning Lofrans has focussed its attention on the product innovation.

*We developed several new solutions like the **AUTOMATIC FREE FALL** which is an optional on some of our horizontal model.*

Our anchor windlass for boats over 60 feet have a transmission made by a planetary-worm screw gears which is very compact in size but at the same time is able to reach high ratio , necessary for boats of these dimensions.

*In the last year we also develop and patented a **built-in solenoid electric motor, with double speed and sensor and magnet included in the motor.***

*In this way the installation of the product was made faster and easier and the reliability of the chain-counter system greatly improved. This motor is installed on our Project 1000 which received a **DAME AWARD** and then was installed on the model **Project 1500 and Project 2000.***

*In parallel we focussed on the remotes control , in particular on the chain counter instruments and in the year 2007 we present **the first hand held radio chain counter the model OCEANIC.** Any Lofrans product is engineered, designed and built focusing on the marine environment.*

The know-how which comes from the huge 40 years experience is put at customers' disposal.

We are able to propose and supply custom products which meet the customer requirements.

The quality of our product is also certified by their own performances which long last.

CONTENTS

▲ VERTICAL ▲ CAPSTANS
▲ HORIZONTAL ▲ DECK HARDWARE & ACCESSORIES

| | | |
|--|---|---|
| <p>470</p>  <p>X1</p> | <p>492</p>  <p>DORADO</p> | <p>504</p>  <p>T 500-700-1000-1500-1700 T 2000-2500 T 3000-4000</p> |
| <p>472 474</p>  <p>X2 PROJECT 1000</p> | <p>493</p>  <p>ATLAS</p> | <p>509</p>  <p>CETO & TENDER WINCH</p> |
| <p>476 478</p>  <p>X3 PROJECT 1500</p> | <p>494</p>  <p>CAYMAN</p> | <p>511</p>  <p>CHAIN STOPPER</p> |
| <p>480</p>  <p>X3,5</p> | <p>495</p>  <p>KOBRA</p> | <p>512</p>  <p>IRIS</p> |
| <p>482</p>  <p>X4 PROJECT 2000</p> | <p>496</p>  <p>TIGRES</p> | <p>513</p>  <p>GALAXY 703 & 503</p> |
| <p>486</p>  <p>X5</p> | <p>497</p>  <p>FALKON</p> | <p>514</p>  <p>GALAXY 102 & RADIO REMOTE CONTROL</p> |
| <p>488</p>  <p>ERCOLE VERTICAL</p> | <p>498</p>  <p>TITAN</p> | <p>515</p>  <p>ACCESSORIES ZUBEHÖR</p> |
| <p>491</p>  <p>ROYAL</p> | <p>500</p>  <p>ERCOLE HORIZONTAL</p> | <p>517</p>  <p>MAINTENANCE KITS WARTUNGSKITS</p> |
| | <p>502</p>  <p>SUPER ERCOLE</p> | <p>520</p>  <p>GYPSIES KETTENNÜSSE</p> |



X SERIES & PROJECT

VERTIKALE ANKERWINDEN

Die X-Serie vertikaler Ankerwinden ist geeignet für Schiffe von 6 bis 27 Metern Länge. Erhältlich sind die Modelle x1, X2, X3 und X4 als Winden mit oder ohne Verholspillkopf. Ferner als 12 oder 24 Volt Version in unterschiedlichen Motorstärken.

Alle X- Serien Modelle sind bereits mit einem Kettenzählsensor vorgerüstet; die Motoren sind wassergeschützt nach IP66, bzw. IP 44.

Die Modelle X2, X3 und X4 können im Notfall auch handbetrieben werden.

X1, X2 und X3 verfügen ferner über kombinierte Tau- Kettennüsse.

Schließlich kann bei diesen Modellen die Kettennuss unabhängig vom Verholspill benutzt werden.

**Bei Lofrans' X-Winden ist das Relais separat und nicht im Motor direkt integriert wie bei den Project Modellen!
Es ist im Lieferumfang enthalten!**



X3.5 - Low profile

VERTICAL WINDLASSES

The X vertical windlass range series is designed to provide anchoring solutions for sail and motor boats from 18 to 100 feet. The X series is made up by the following models: X1, X2, X3, X3.5, X4 and X5 all available in standard version with drum and in low profile version. The Project versions have a built-in control box within the motor casing. All models are available in different motorization to meet any customers' requirements.

The X range, as standard, comes in mirror polished marine bronze produced by hot forging.

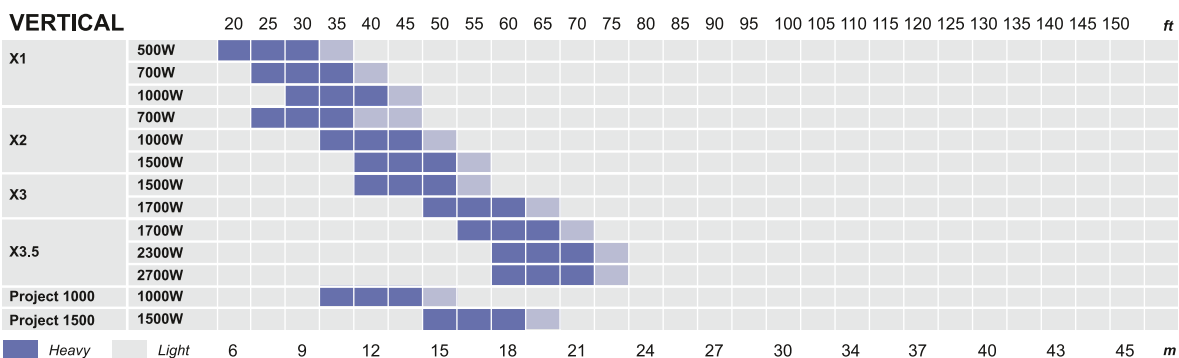

X1 - Vertical Windlass

500W / 700W



With Drum / mit Verholspill



Low Profile / ohne Verholspill

Hauptmerkmale

- Bronze verchromte Basis und Trommel
- Mit oder ohne Spillkopf
- Wahlweise nur Kettenussantrieb oder mit Verholspill (Trommel)
- Kettenuss für Tau- und Kette
- Freilauf
- Intelligentes Kettenablaufsystem
- Vorgeüstet mit Kettenzählersensor
- Leistungsstarker IP67 wassergeschützter Motor
- Eloxierte Getriebeeinheit aus seewasserbeständigem Aluminium

| Construction | Chromed bronze | |
|---------------------------------------|---------------------|---------|
| Motor size | 500 W | 700 W |
| Power Supply (V) | 12 | 12 |
| Maximum Pull (kg) | 630 | 700 |
| Working load (kg) | 70 | 80 |
| Amps at Working Load (A) | 75 | 80 |
| Line Speed at Working Load (m/min) | 23 | 25 |
| Max Line Speed (m/min) | 26 | 28 |
| Net Weight Low Profile (kg) | 11 | 13 |
| Net Weight with Drum (kg) | 12 | 14 |
| Circuit Breaker (available separatly) | L187331 | L187332 |
| Control Box | Included in package | |

| X1 | | | | | |
|-------------|--------------------------|--------------------|--|--|--|
| With Drum | 6 mm, ISO 4565 / DIN 766 | 10-12 mm, 3-strand | | | |
| | 8 mm, ISO 4565 / DIN 766 | 12 mm, 3-strand | | | |
| Low Profile | 6 mm, ISO 4565 / DIN 766 | 10-12 mm, 3-strand | | | |
| | 8 mm, ISO 4565 / DIN 766 | 12 mm, 3-strand | | | |

Best-Nr.: verchromte Ausführung:
LX150A12 X1 / 12V / 500W OHNE SPILL
LX150B12 X1 / 12V / 500W MIT SPILL

Best-Nr.: verchromte Ausführung:
LX170A12 X1 / 12V / 700W OHNE SPILL
LX170B12 X1 / 12V / 700W MIT SPILL

Bitte die Kettenuss exakt angeben: Wir benötigen die Größe und: ob Sie **DIN-, ISO- oder Zoll-Ketten-**nuss benötigen!



Abstreifarm



Von Lofrans entwickeltes Marine-Aluminium-Getriebe



IP 67 wassergeschützte Motoreinheit

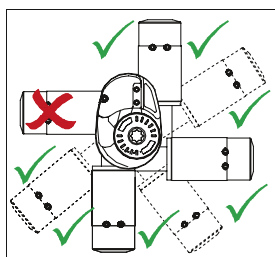

Im Lieferumfang enthalten:

- Relaisbox
- Kurbel
- Kettennuss
- CD mit Anleitung

Lieferbare Ersatz-Kettennüsse



Best-Nr. Typ Kettennuss

| | |
|----------|--------------------------|
| L 630970 | 6 mm, ISO 4565 / DIN 766 |
| L 630980 | 7 mm, ISO 4565 |
| L 630999 | 8 mm, ISO 4565 / DIN 766 |

Erhältliches Zubehör

- Fußtaster
- Sicherungsautomat
- Tastpaneel
- Kettenzähler
- Handfernbedienung
- Funkfernbedienung



Dimensions in mm

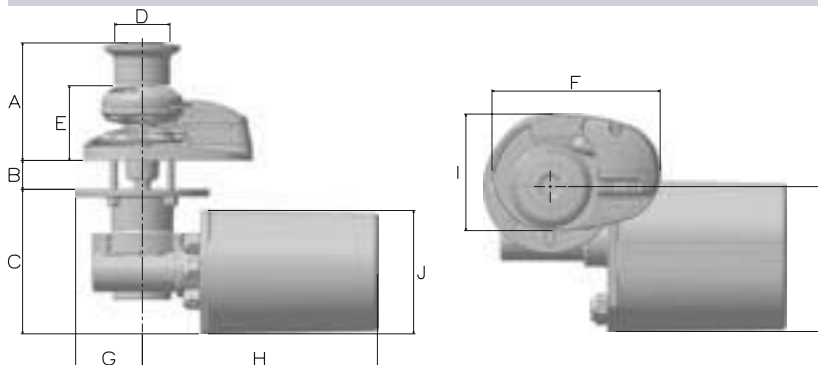

| Model | A | B | C | D | E* | F | G | H | I | J | L |
|-------|-----|-------|-----|-----|----|-----|----|-----|-----|-----|-----|
| 500W | 130 | 10-30 | 111 | Ø60 | 84 | 183 | 56 | 236 | 127 | 105 | 132 |
| 700W | 130 | 10-30 | 111 | Ø60 | 84 | 183 | 56 | 236 | 127 | 105 | 132 |

*Low Profile height dimensions.

KEEP YOUR LOFRANS' AS GOOD AS NEW!



Wartungskit
Bestell-Nr. L 72037

www.lofrans.com

X2 - Vertical Windlass

700W / 1000W



Hauptmerkmale

- Bronze verchromte Basis und Trommel
- Mit oder ohne Spillkopf
- Wahlweise nur Kettennussantrieb oder mit Verholspill (Trommel)
- Kettennuss für Tau- und Kette
- Freilauf
- Intelligentes Kettenablaufsystem
- Vorerüstet mit Kettenzählersensor
- Leistungsstarker IP67 wassergeschützter Motor
- Eloxierte Getriebeeinheit aus seewasserbeständigem Aluminium

With Drum / mit Verholspill



Construction

| Motor size |
|--|
| Power Supply (V) |
| Maximum Pull (kg) |
| Working load (kg) |
| Amps at Working Load (A) |
| Line Speed at Working Load (m/min) |
| Max Line Speed (m/min) |
| Net Weight Low Profile (kg) |
| Net Weight with Drum (kg) |
| Circuit Breaker (available separately) |
| Control Box |

Chromed bronze

| 700W | | 1000 W | |
|---------|---------|---------|---------|
| 12 | 24 | 12 | 24 |
| 850 | 850 | 1000 | 1060 |
| 80 | 80 | 165 | 165 |
| 90 | 45 | 135 | 70 |
| 26 | 26 | 20 | 23 |
| 35 | 35 | 40 | 40 |
| 21 | 21 | 23 | 23 |
| 23 | 23 | 24 | 24 |
| L187332 | L187331 | L187333 | L187332 |

Included in package

| X2 |  |  |
|-------------|---|---|
| With Drum | 6 mm, ISO 4565 / DIN 766 | - |
| | 8 mm, ISO 4565 / DIN 766 | 14 mm, 3-strand |
| | 10 mm, DIN 766 | - |
| | 10 mm, ISO 4565 | - |
| Low Profile | 6 mm, ISO 4565 / DIN 766 | - |
| | 8 mm, ISO 4565 / DIN 766 | 14 mm, 3-strand |
| | 10 mm, DIN 766 | - |
| | 10 mm, ISO 4565 | - |

Best-Nr.: verchromte Ausführung:
LX210A12 X2 / 12V / 1000W OHNE SPILL
LX210A24 X2 / 24V / 1000W OHNE SPILL

Best-Nr.: verchromte Ausführung:
LX210B12 X2 / 12V / 1000W MIT SPILL
LX210B24 X2 / 24V / 1000W MIT SPILL

Bitte die Kettennuss exakt angeben: Wir benötigen die Größe und: ob Sie **DIN-, ISO-** oder **Zoll-Kettennuss** benötigen!

Modell 700W und weitere Modelle auf Anfrage.

*Non-standard configuration optional gypsies can be supplied separately. Please refer to compatible gypsies table on next page.

THE ORIGINAL WINDLASS



Low Profile / ohne Verholpill



Im Lieferumfang enthalten:

- Relaisbox
- Kurbel
- Kettennuss
- CD mit Anleitung

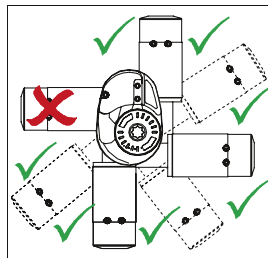

Dimensions in mm

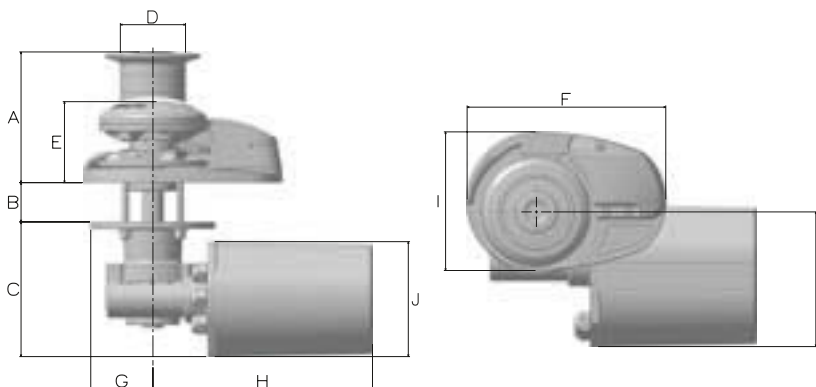

| Model | A | B | C | D | E* | F | G | H | I | J | L |
|--------------|-----|-------|-----|-----|----|-----|----|-----|-----|-----|-----|
| 700W | 153 | 25-40 | 155 | Ø76 | 95 | 232 | 73 | 260 | 162 | 134 | 165 |
| 1000W | 153 | 25-40 | 155 | Ø76 | 95 | 232 | 73 | 260 | 162 | 134 | 165 |

*Low Profile height dimensions.

Lieferbare Ersatz-Kettennüsse



Best-Nr. Typ Kettennuss

| | |
|----------|--------------------------|
| L 630953 | 6 mm, ISO 4565 / DIN 766 |
| L 630949 | 8 mm, ISO 4565 / DIN 766 |
| L 630951 | 10mm, ISO 4565 |
| L 630955 | 10mm, / DIN 766 |

Erhältliches Zubehör

- Fußtaster
- Sicherungsautomat
- Tastpaneel
- Kettenzähler
- Handfernbedienung
- Funkfernbedienung



KEEP YOUR LOFRANS' AS GOOD AS NEW!



Wartungskit
Bestell-Nr. L 72039

www.lofrans.com



PROJECT 1000



mit Verholspill

Hauptmerkmale

- Bronze verchromte Basis und Trommel
- Spezielle, wassergeschützte Kugellagereinheiten
- Mit oder ohne Spillkopf
- Wahlweise nur Kettennussantrieb oder mit Verholspill (Trommel)
- Kettennuss für Tau- und Kette
- Freilauf
- Kettenablauf händisch steuerbar
- Optimale Kettensteuerung durch Federfinger
- Vorerüstet mit Kettenzählersensor
- Leistungsstarker IP67 wassergeschützter Motor
- Eloxierte Getriebeeinheit aus seewasserbeständigem Aluminium

Best-Nr.: verchromte Ausführung:
LPJ10B12 PROJECT 1000 / 12V / 1000W MIT SPILL
LPJ10B24 PROJECT 1000 / 24V / 1000W MIT SPILL

Best-Nr.: verchromte Ausführung:
LPJ10A12 PROJECT 1000 / 12V / 1000W OHNE SPILL
LPJ10A24 PROJECT 1000 / 24V / 1000W OHNE SPILL

Bitte die Kettennuss exakt angeben:
 Wir benötigen die Größe und ob Sie
 DIN-, ISO- oder ZOLL - Kettennuss benötigen.

| Construction | Chromed bronze | |
|--|----------------|---------|
| | 1000 W | |
| Motor size | | |
| Power Supply (V) | 12 | 24 |
| Maximum Pull (kg) | 1000 | 1060 |
| Working load (kg) | 165 | 165 |
| Amps at Working Load (A) | 135 | 70 |
| Line Speed at Working Load (m/min) | 22 | 25 |
| Max Line Speed (m/min) | 50 | 50 |
| Net Weight Low Profile (kg) | 22 | 22 |
| Net Weight with Drum (kg) | 24 | 24 |
| Circuit Breaker (available separately) | L187333 | L187332 |
| Control Box | Build in | |

| PROJECT 1000 | | |
|--------------|--------------------------|-----------------|
| With Drum | 8 mm, ISO 4565 / DIN 766 | 14 mm, 3-strand |
| | 10 mm, DIN 766 | - |
| | 10 mm, ISO 4565 | - |
| Low Profile | 8 mm, ISO 4565 / DIN 766 | 14 mm, 3-strand |
| | 10 mm, DIN 766 | - |
| | 10 mm, ISO 4565 | - |

Bei der Projectserie ist das Relais bereits im Motor integriert und daher im Lieferumfang enthalten.

*Non-standard configuration optional gypsies can be supplied separately. Please refer to compatible gypsies table on next page.

THE ORIGINAL WINDLASS



- Vertical Windlass

1000W



Low Profile / ohne Verholspill

Im Lieferumfang enthalten:

- Kurbel
- Kettennuss
- CD mit Anleitung

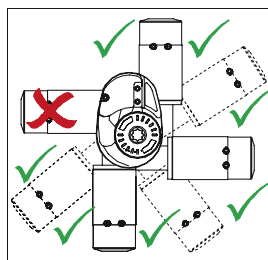

Dimensions in mm

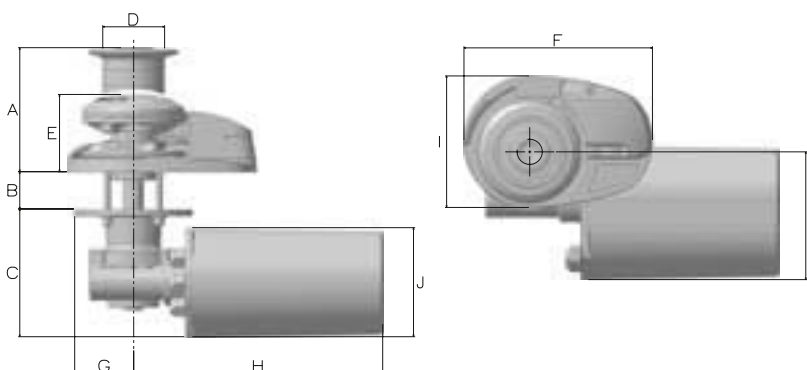

| Model | A | B | C | D | E* | F | G | H | I | J | L |
|-------|-----|-------|-----|-----|----|-----|----|-----|-----|-----|-----|
| 1000W | 153 | 25-40 | 155 | Ø76 | 95 | 232 | 73 | 306 | 162 | 134 | 165 |

*Low Profile height dimensions.

Lieferbare Ersatz-Kettennüsse



Best-Nr. Typ Kettennuss

| | |
|----------|--------------------------|
| L 630953 | 6 mm, ISO 4565 / DIN 766 |
| L 630949 | 8 mm, ISO 4565 / DIN 766 |
| L 630951 | 10mm, ISO 4565 |
| L 630955 | 10mm, / DIN 766 |

Erhältliches Zubehör

- Fußtaster
- Sicherungsautomat
- Tastpaneel
- Kettenzähler
- Handfernbedienung
- Funkfernbedienung



KEEP YOUR LOFRANS' AS GOOD AS NEW!



Wartungskit
Bestell-Nr. L 72038

www.lofrans.com

X3 - Vertical Windlass

1500W / 1700W



mit Verholspill

Hauptmerkmale



- Bronze verchromte Basis und Trommel
- Spezielle, wassergeschützte Kugellagereinheiten
- Mit oder ohne Spillkopf
- Wahlweise nur Kettennussantrieb oder mit Verholspill (Trommel)
- Kettennuss für Tau- und Kette
- Freilauf
- Kettenablauf händisch steuerbar
- Optimale Kettensteuerung durch Federfinger
- Vorerüstet mit Kettenzählersensor
- Leistungsstarker IP67 wassergeschützter Motor
- Eloxierte Getriebeeinheit aus seewasserbeständigem Aluminium

Best-Nr.: verchromte Ausführung:
LX315A12 X3 / 12V / 1500W OHNE SPILL
LX315B12 X3 / 12V / 1500W MIT SPILL
LX317A12 X3 / 12V / 1700W OHNE SPILL

Best-Nr.: verchromte Ausführung:
LX317A24 X3 / 24V / 1700W OHNE SPILL
LX317B12 X3 / 12V / 1700W MIT SPILL
LX317B24 X3 / 24V / 1700W MIT SPILL

Bitte die Kettennuss exakt angeben:
 Wir benötigen die Größe und ob Sie
 DIN-, ISO- oder ZOLL - Kettennuss benötigen.

| Construction | Chromed bronze | | |
|---------------------------------------|---------------------|---------|---------|
| | 1500W | 1700 W | |
| Motor size | | | |
| Power Supply (V) | 12 | 12 | 24 |
| Maximum Pull (kg) | 1200 | 1600 | 1695 |
| Working load (kg) | 190 | 270 | 270 |
| Amps at Working Load (A) | 150 | 180 | 90 |
| Line Speed at Working Load (m/min) | 17 | 14 | 15 |
| Max Line Speed (m/min) | 40 | 32 | 32 |
| Net Weight Low Profile (kg) | 32 | 35 | 35 |
| Net Weight with Drum (kg) | 35 | 38 | 38 |
| Circuit Breaker (available separatly) | L187333 | L187334 | L187332 |
| Control Box | Included in package | | |

| X3 |  |  |
|-------------|---|---|
| With Drum | 8 mm, ISO 4565 / DIN 766 | 14 mm, 3-strand |
| | 10 mm, DIN 766 | 16 mm, 3-strand |
| | 10 mm, ISO 4565 | 16 mm, 3-strand |
| | 12 mm, ISO 4565 / 13mm, DIN 766 | 18 mm, 3-strand |
| Low Profile | 8 mm, ISO 4565 / DIN 766 | 14 mm, 3-strand |
| | 10 mm, DIN 766 | 16 mm, 3-strand |
| | 10 mm, ISO 4565 | 16 mm, 3-strand |
| | 12 mm, ISO 4565 / 13mm, DIN 766 | 18 mm, 3-strand |

*Non-standard configuration optional gypsies can be supplied separately. Please refer to compatible gypsies table on next page.

THE ORIGINAL WINDLASS



Low Profile / ohne Verholspill

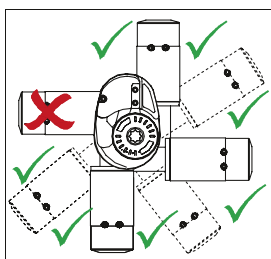

Im Lieferumfang enthalten:

- Relaisbox
- Kurbel
- Kettennuss
- CD mit Anleitung

Lieferbare Ersatz-Kettennüsse



Best-Nr. Typ Kettennuss

| | |
|----------|--------------------------|
| L 630957 | 8 mm, ISO 4565 / DIN 766 |
| L 630966 | 10mm, / DIN 766 |
| L 630959 | 10mm, ISO 4565 |
| L 630961 | 12mm, ISO 4565 |

Erhältliches Zubehör

- Fußtaster
- Sicherheitsautomat
- Tastpaneel
- Kettenzähler
- Handfernbedienung
- Funkfernbedienung



Dimensions in mm

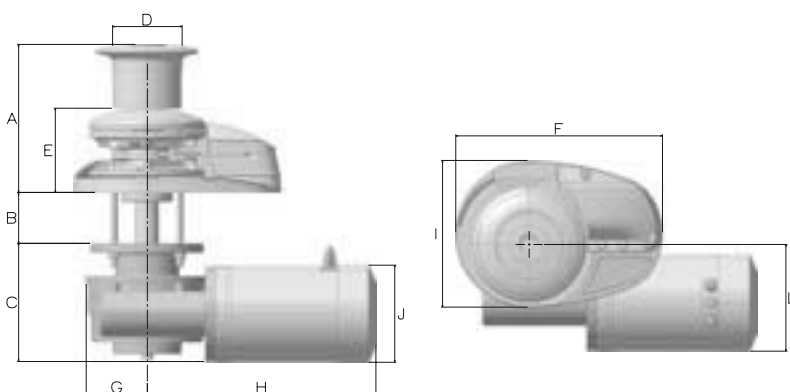

| Model | A | B | C | D | E* | F | G | H | I | J | L |
|-------|-----|-------|-----|-----|-----|-----|----|-----|-----|------|-----|
| 1500W | 195 | 50-70 | 155 | Ø92 | 110 | 270 | 80 | 255 | 192 | 134 | 145 |
| 1700W | 195 | 50-70 | 155 | Ø92 | 110 | 270 | 80 | 300 | 192 | Ø127 | 140 |

*Low Profile height dimensions.



Lofrans Kettenstopper, Edelstahl, geeignet für Kette 12, 13, 14 mm.

Bestell-Nr. L 72191



Wartungskit
Bestell-Nr. L 72040

www.lofrans.com

PROJECT 1500



Hauptmerkmale

- Bronze verchromte Basis und Trommel
- Spezielle, wassergeschützte Kugellagereinheiten
- Mit oder ohne Spillkopf
- Wahlweise nur Kettennussantrieb oder mit Verholspill (Trommel)
- Kettennuss für Tau- und Kette
- Freilauf
- Kettenablauf händisch steuerbar
- Optimale Kettensteuerung durch Federfinger
- Vorgerüstet mit Kettenzählersensor
- Leistungsstarker IP66 wassergeschützter Motor
- Eloxierte Getriebeeinheit aus seewasserbeständigem Aluminium



Best-Nr.: verchromte Ausführung:
LPJ15A12 PROJECT 1500 / 12V / 1500W OHNE SPILL
LPJ15A24 PROJECT 1500 / 24V / 1500W OHNE SPILL

Best-Nr.: verchromte Ausführung:
LPJ15B12 PROJECT 1500 / 12V / 1500W MIT SPILL
LPJ15B24 PROJECT 1500 / 24V / 1500W MIT SPILL

mit Verholspill

Bitte die Kettennuss exakt angeben: Wir benötigen die Größe und: ob Sie **DIN-, ISO-** oder **Zoll-Ketten-**nuss benötigen!

| Construction | Chromed bronze | |
|--|----------------|----------------|
| | 1500 W | |
| Motor size | | |
| Power Supply (V) | 12 | 24 |
| Maximum Pull (kg) | 1600 | 1695 |
| Working load (kg) | 270 | 270 |
| Amps at Working Load (A) | 180 | 90 |
| Line Speed at Working Load (m/min) | 14 | 15 |
| Max Line Speed (m/min) | 32 | 32 |
| Net Weight Low Profile (kg) | 36 | 36 |
| Net Weight with Drum (kg) | 39 | 39 |
| Circuit Breaker (available separately) | L187333 | L187332 |
| Control Box | Build in | |

| PROJECT 1500 |  |  |
|--------------|---|---|
| With Drum | 8 mm, ISO 4565 / DIN 766 | 14 mm, 3-strand |
| | 10 mm, DIN 766 | 16 mm, 3-strand |
| | 10 mm, ISO 4565 | 16 mm, 3-strand |
| | 12 mm, ISO 4565 / 13mm, DIN 766 | 18 mm, 3-strand |
| Low Profile | 8 mm, ISO 4565 / DIN 766 | 14 mm, 3-strand |
| | 10 mm, DIN 766 | 16 mm, 3-strand |
| | 10 mm, ISO 4565 | 16 mm, 3-strand |
| | 12 mm, ISO 4565 / 13mm, DIN 766 | 18 mm, 3-strand |

Bei der Projectserie ist das Relais bereits im Motor integriert und daher im Lieferumfang enthalten.

*Non-standard configuration optional gypsies can be supplied separately. Please refer to compatible gypsies table on next page.

THE ORIGINAL WINDLASS



- Vertical Windlass

1500W



*Low Profile /
ohne Verholspill*

Im Lieferumfang enthalten:

- Kurbel
- Kettennuss
- CD mit Anleitung

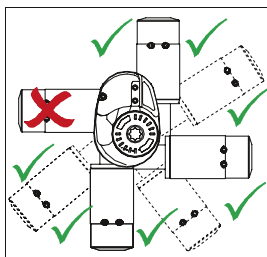

Dimensions in mm

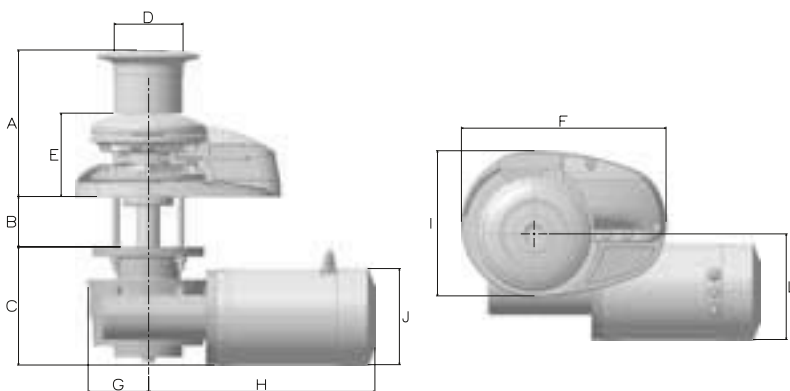

| Model | A | B | C | D | E* | F | G | H | I | J | L |
|-------|-----|-------|-----|-----|-----|-----|----|-----|-----|------|-----|
| 1500W | 195 | 50-70 | 155 | Ø92 | 110 | 270 | 80 | 365 | 192 | Ø127 | 145 |

*Low Profile height dimensions.

**Lieferbare Ersatz-
Kettennüsse**



Best-Nr. Typ Kettennuss

| | |
|----------|--------------------------|
| L 630957 | 8 mm, ISO 4565 / DIN 766 |
| L 630966 | 10mm, / DIN 766 |
| L 630959 | 10mm, ISO 4565 |
| L 630961 | 12mm, ISO 4565 |

Erhältliches Zubehör

- Fußtaster
- Sicherungs-
automat
- Tastpaneel
- Kettenzähler
- Handfernbedienung
- Funkfernbedienung



Lofrans Kettensstopper, Edelstahl, geeignet für Kette 12, 13, 14 mm.

Bestell-Nr. L 72191



Wartungskit

Bestell-Nr. L 72040

www.lofrans.com

X3.5 - Vertical Windlass

1700W / 2300W / 2700W



mit Verholspill

Hauptmerkmale

- Basis und Trommel aus hochwertigem Edelstahl
- Modell mit Verholspill und ohne Verholspill
- Verholspill und Kettennuss einzeln ansteuerbar
- Kettenablauf händisch steuerbar
- Kettensensor bereits vorinstalliert
- Getriebeeinheit aus seewasserbeständigem Aluminium
- Leistungsstarker, wassergeschützter Motor

| | |
|------------------|-------------------------------|
| Best-Nr.: | verchromte Ausführung |
| LX3517A12 | X3.5 / 12V / 1700W OHNE SPILL |
| LX3517B12 | X3.5 / 12V / 1700W MIT SPILL |
| LX3517A24 | X3.5 / 24V / 1700W OHNE SPILL |
| LX3517B24 | X3.5 / 24V / 1700W MIT SPILL |
| LX3523A24 | X3.5 / 24V / 2300W OHNE SPILL |
| LX3523B24 | X3.5 / 24V / 2300W MIT SPILL |
| LX3527A24 | X3.5 / 24V / 2700W OHNE SPILL |
| LX3523B24 | X3.5 / 24V / 2700W MIT SPILL |

| Construction | 316 L Stainless Steel | | | |
|---------------------------------------|-----------------------|---------|---------|---------|
| | 1700 W | | 2300 W | 2700W |
| Motor size | | | | |
| Power Supply (V) | 12 | 24 | 24 | 24 |
| Maximum Pull (kg) | 1700 | 1700 | 1900 | 2000 |
| Working load (kg) | 270 | 270 | 330 | 400 |
| Amps at Working Load (A) | 185 | 95 | 180 | 210 |
| Line Speed at Working Load (m/min) | 15 | 16 | 16 | 16 |
| Max Line Speed (m/min) | 37 | 37 | 35 | 35 |
| Net Weight Low Profile (kg) | 50 | 50 | 60 | 60 |
| Net Weight with Drum (kg) | 48 | 48 | 58 | 58 |
| Circuit Breaker (available separatly) | L187334 | L187332 | L187333 | L187333 |
| Control Box | Included in package | | | |

| X3,5 |  |
|------------------------|---|
| | 10 mm, ISO 4565 |
| With Drum | 12 mm, ISO 4565 / 13mm, DIN 766 |
| | 14 mm |
| new Low Profile | 12 mm, ISO 4565 / 13mm, DIN 766 |

Bitte die Kettennuss exakt angeben:

Wir benötigen die Größe und ob Sie DIN-, ISO- oder ZOLL - Kettennuss benötigen.

*Non-standard configuration optional gypsies can be supplied separately. Please refer to compatible gypsies table on next page.

THE ORIGINAL WINDLASS



Chain Pipe /
Ketteneinlass



Low Profile / ohne Verholspill

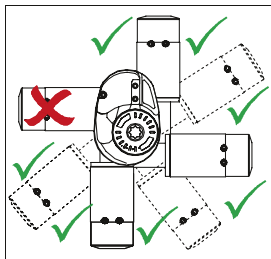

Im Lieferumfang enthalten:

- Kurbel
- Kettennuss
- CD mit Anleitung

Dimensions in mm

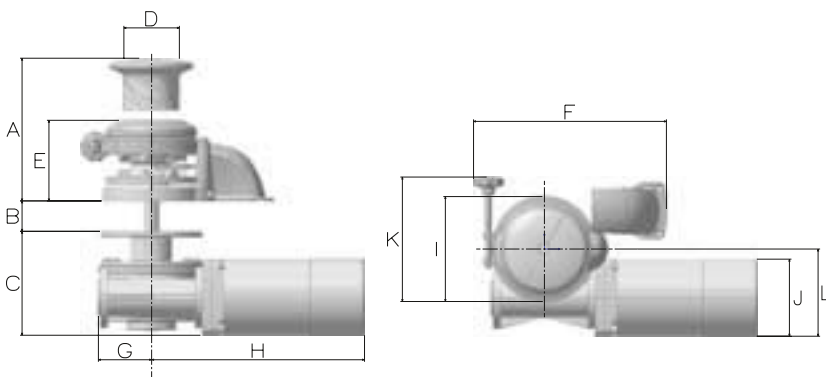

| Model | A | B | C | D | E* | F | G | H | I | J | K | L |
|-------|-----|-------|-----|------|-----|-----|-----|-----|------|------|-----|-----|
| 1700W | 281 | 40-60 | 208 | Ø110 | 160 | 380 | 80 | 300 | Ø210 | Ø127 | 236 | 140 |
| 2300W | 281 | 40-60 | 208 | Ø110 | 160 | 380 | 105 | 420 | Ø210 | Ø150 | 236 | 175 |
| 2700W | 281 | 40-60 | 208 | Ø110 | 160 | 380 | 105 | 420 | Ø210 | Ø150 | 236 | 175 |

*Low Profile height dimensions.

**Lieferbare Ersatz-
Kettennüsse**



Best-Nr. Typ Kettennuss

| | |
|----------|--------------------------|
| L 630996 | 8 mm, ISO 4565 / DIN 766 |
| L 631022 | 10mm, ISO 4565 |
| L 631132 | 10mm, |
| L 631045 | 13mm / DIN 766 |
| L 631059 | 14mm |
| L 631033 | 1/2" BBB |
| L 631036 | 1/2" G40 |

Erhältliches Zubehör

- Fußtaster
- Sicherheits-
automat
- Tastpaneel
- Kettenzähler
- Handfern-
bedienung
- Funkfern-
bedienung



Lofrans Kettensstopper, Edelstahl, geeignet für Kette 12, 13, 14 mm.

Bestell-Nr. L 72191

www.lofrans.com

X4 - Vertical Windlass

2300W / 2700W / Hydraulic - 8cc

mit Verholspill



Hauptmerkmale

- Bronze verchromte Basis und Trommel
- Mit oder ohne Spillkopf
- Wahlweise nur Kettennussantrieb oder mit Verholspill (Trommel)
- Kettennuss für Tau- und Kette
- Freilauf
- Intelligentes Kettenablaufsystem
- Vorgerüstet mit Kettenzählersensor
- Leistungsstarker wassergeschützter Motor

Im Lieferumfang enthalten:

- Relaisbox
- Kurbel
- Kettennuss
- CD mit Anleitung

| Construction | Chromed bronze | | |
|---------------------------------------|---------------------|-------|-----------------|
| | 2300 W | 2700W | Hydraulic - 8cc |
| Motor size | 2300 W | 2700W | Hydraulic - 8cc |
| Power Supply (V) | 24 | 24 | - |
| Maximum Pull (kg) | 2100 | 2500 | 2500 |
| Working load (kg) | 500 | 530 | 650 |
| Amps at Working Load (A) | 160 | 170 | - |
| Line Speed at Working Load (m/min) | 13 | 13 | 16 |
| Max Line Speed (m/min) | 25 | 28 | 16 |
| Net Weight Low Profile (kg) | 72 | 75 | 55 |
| Net Weight with Drum (kg) | 82 | 85 | 60 |
| Hydraulic Pressure (bar) | - | - | 200 |
| Hydraulic Flow (lt/min) | - | - | 32 |
| Circuit Breaker (available separatly) | L187333 | - | - |
| Control Box | Included in package | | - |

| X4 | |
|-------------|---------------------------------|
| With Drum | 10 mm, ISO 4565 |
| | 12 mm, ISO 4565 / 13mm, DIN 766 |
| | 14 mm |
| Low Profile | 12 mm, ISO 4565 / 13mm, DIN 766 |
| | 14 mm |
| | 12 mm, ISO 4565 / 13mm, DIN 766 |

| | |
|------------------|-----------------------------|
| Best-Nr.: | verchromte Ausführung |
| LX423A24 | X4 / 24V / 2300W OHNE SPILL |
| LX423B24 | X4 / 24V / 2300W MIT SPILL |
| LX427A24 | X4 / 24V / 2700W OHNE SPILL |
| LX427B24 | X4 / 24V / 2700W MIT SPILL |

Hydraulisches Modell auf Anfrage.

Bitte die Kettennuss exakt angeben:

Wir benötigen die Größe und ob Sie DIN-, ISO- oder ZOLL - Kettennuss benötigen.

*Non-standard configuration optional gypsies can be supplied separately. Please refer to compatible gypsies table on next page.

** cw: the windlass pulls clockwise ccw: the windlass pulls counter clockwise

THE ORIGINAL WINDLASS

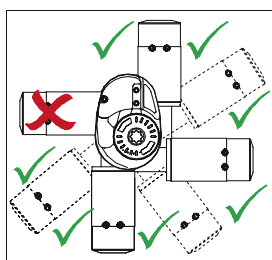

Lofrans Kettenstopper,
Edelstahl, geeignet
für Kette 12, 13, 14 mm.
Bestell-Nr. L 72191



Dimensions in mm

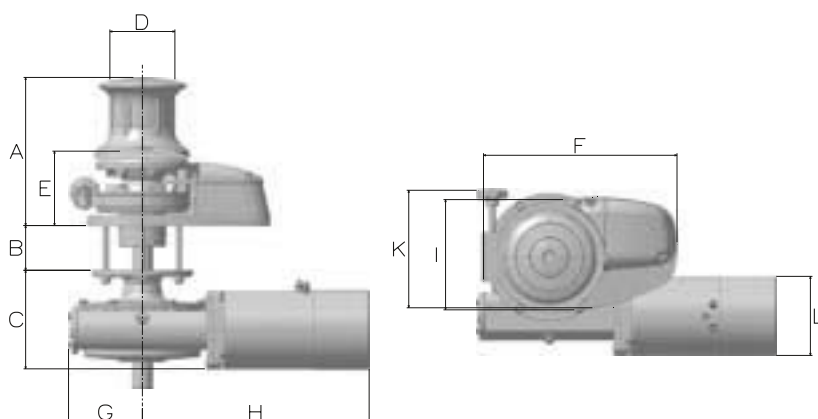

| Model | A | B | C | D | E* | F | G | H | I | J | K | L |
|-------|-----|--------|-----|------|-----|-----|-----|-----|-----|------|-----|-----|
| 2300W | 285 | 60-130 | 200 | Ø125 | 150 | 380 | 140 | 449 | 220 | Ø152 | 240 | 190 |
| 2700W | 285 | 60-130 | 200 | Ø125 | 150 | 380 | 140 | 449 | 220 | Ø152 | 240 | 190 |

* Low Profile height dimensions.

Lieferbare Ersatz-Kettennüsse



Best-Nr. Typ Kettennuss

| | |
|----------|--------------------------------|
| L 630996 | 8 mm, ISO 4565 / DIN 766 |
| L 631022 | 10mm, ISO 4565 |
| L 631132 | 10mm, / DIN 766 |
| L 631031 | 12mm, ISO 4565 / 13mm, DIN 766 |
| L 631059 | 14mm |
| L 631033 | 1/2" BBB |
| L 631036 | 1/2" G40 HT |

Wartungskit

Bestell-Nr. Beschreibung

| | |
|----------|---------------------|
| L 474013 | KIT A - Dichtungen |
| L 474012 | KIT B - Schrauben |
| L 474011 | KIT C - Bolzen |
| L 474010 | KIT D - Sprengringe |

Erhältliches Zubehör

- Fußtaster
- Sicherungsautomat
- Tastpaneel
- Kettenzähler
- Handfernbedienung
- Funkfernbedienung



www.lofrans.com

PROJECT 2000

mit Verholspill



Hauptmerkmale

- Bronze verchromte Basis und Trommel
- Spezielle, wassergeschützte Kugellagereinheiten
- Mit oder ohne Spillkopf
- Wahlweise nur Kettennussantrieb oder mit Verholspill (Trommel)
- Kettennuss für Tau- und Kette
- Freilauf
- Kettenablauf händisch steuerbar
- Vorgeüstet mit Kettenzählersensor
- Motor mit integriertem Relais
- Eloxierte Getriebeeinheit aus seewasserbeständigem Aluminium

| Construction | Chromed bronze |
|------------------------------------|----------------|
| Motor size | 2000 W |
| Power Supply (V) | 24 |
| Maximum Pull (kg) | 2100 |
| Working load (kg) | 500 |
| Amps at Working Load (A) | 160 |
| Line Speed at Working Load (m/min) | 13 |
| Max Line Speed (m/min) | 25 |
| Net Weight Low Profile (kg) | 76 |
| Net Weight with Drum (kg) | 86 |
| Circuit Breaker | L187333 |
| Control Box | Build in |

| PROJECT 2000 | |
|--------------|---------------------------------|
| With Drum | 12 mm, ISO 4565 / 13mm, DIN 766 |
| | 14 mm |
| Low Profile | 10 mm, DIN 766 |
| | 10 mm, ISO 4565 |
| | 12 mm, ISO 4565 / 13mm, DIN 766 |

Bei der Projectserie ist das Relais bereits im Motor integriert und daher im Lieferumfang enthalten.

Best-Nr.: verchromte Ausführung
LPJ20A24 PROJECT 2000 / 24V / 2000W OHNE SPILL
LPJ20B24 PROJECT 2000 / 24V / 2000W MIT SPILL

Bitte die Kettennuss exakt angeben:
 Wir benötigen die Größe und ob Sie DIN-, ISO- oder ZOLL - Kettennuss benötigen.

**Non-standard configuration optional gypsies can be supplied separately. Please refer to compatible gypsies table on next page.*

THE ORIGINAL WINDLASS



- Vertical Windlass

2000W



*Low Profile /
ohne Verholspill*

Im Lieferumfang enthalten:

- Kurbel
- Kettennuss
- CD mit Anleitung

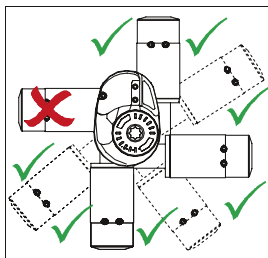

Dimensions in mm

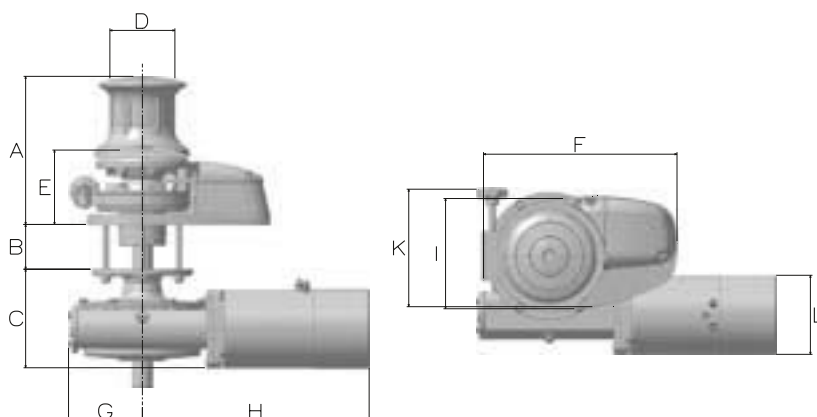

| Model | A | B | C | D | E* | F | G | H | I | J | K | L |
|-------|-----|--------|-----|------|-----|-----|-----|-----|-----|------|-----|-----|
| 2000W | 285 | 60-130 | 200 | Ø125 | 150 | 380 | 140 | 499 | 220 | Ø152 | 240 | 190 |

*Low Profile height dimensions.

**Lieferbare Ersatz-
Kettennüsse**



Best-Nr. Typ Kettennuss

| | |
|----------|--------------------------------|
| L 630996 | 8 mm, ISO 4565 / DIN 766 |
| L 631022 | 10mm, ISO 4565 |
| L 631132 | 10mm, / DIN 766 |
| L 631031 | 12mm, ISO 4565 / 13mm, DIN 766 |
| L 631059 | 14mm |
| L 631033 | 1/2" BBB |
| L 631036 | 1/2" G40 HT |

Wartungskit

Bestell-Nr. Beschreibung

| | |
|----------|---------------------|
| L 474013 | KIT A - Dichtungen |
| L 474012 | KIT B - Schrauben |
| L 474011 | KIT C - Bolzen |
| L 474010 | KIT D - Sprengringe |

Erhältliches Zubehör

- Fußtaster
- Sicherungs-
automat
- Tastpaneel
- Kettenzähler
- Handfernbedienung
- Funkfernbedienung



Lofrans Kettenstopper, Edelstahl, geeignet für Kette 12, 13, 14 mm.

Bestell-Nr. L 72191

www.lofrans.com

X5 - Vertical Windlass

3000W / Hydraulic



Hauptmerkmale

- Bronze verchromte Basis und Trommel
- Mit oder ohne Spillkopf
- Wahlweise nur Kettennussantrieb oder mit Verholspill (Trommel)
- Kettennuss für Tau- und Kette
- Freilauf
- Intelligentes Kettenablaufsystem
- Vorgerüstet mit Kettenzählersensor
- Leistungstarker wassergeschützter Motor

| Construction | 316 L Stainless Steel | |
|------------------------------------|-----------------------|-----------------|
| | 3000 W | Hydraulic - 8cc |
| Motor size | 3000 W | Hydraulic - 8cc |
| Power Supply (V) | 24 | - |
| Maximum Pull (kg) | 2700 | 2700 |
| Working load (kg) | 550 | 650 |
| Amps at Working Load (A) | 210 | - |
| Line Speed at Working Load (m/min) | 17 | 21 |
| Max Line Speed (m/min) | 33 | 21 |
| Net Weight with Drum (kg) | 100 | 85 |
| Hydraulic Pressure (bar) | - | 200 |
| Hydraulic Flow (l/min) | - | 32 |
| Control Box | Included in package | |

| X5 |  |
|-----------|---|
| With Drum | 12 mm, ISO 4565 / 13mm, DIN 766 |
| | 14 mm |

Best-Nr.: verchromte Ausführung
LX530A24 X5 / 24V / 2700W OHNE SPILL
LX530B24 X5 / 24V / 2700W MIT SPILL
 Hydraulisches Modell auf Anfrage.

Bitte die Kettennuss exakt angeben:

Wir benötigen die Größe und ob Sie DIN-, ISO- oder ZOLL - Kettennuss benötigen.

**Non-standard configuration optional gypsies can be supplied separately. Please refer to compatible gypsies table on next page.*

THE ORIGINAL WINDLASS



*Chain Pipe /
Ketteneinlass*

Im Lieferumfang enthalten:

- Relaisbox
- Kurbel
- Kettennuss
- CD mit Anleitung



Lofrans Kettensstopper, Edelstahl, geeignet für Kette 12, 13, 14 mm.

Bestell-Nr. L 72191

**Lieferbare Ersatz-
Kettennüsse**



Best-Nr. Typ Kettennuss

- L 631039 12mm, ISO 4565 / 13mm, DIN 766
- L 631065 14mm



Dimensions in mm

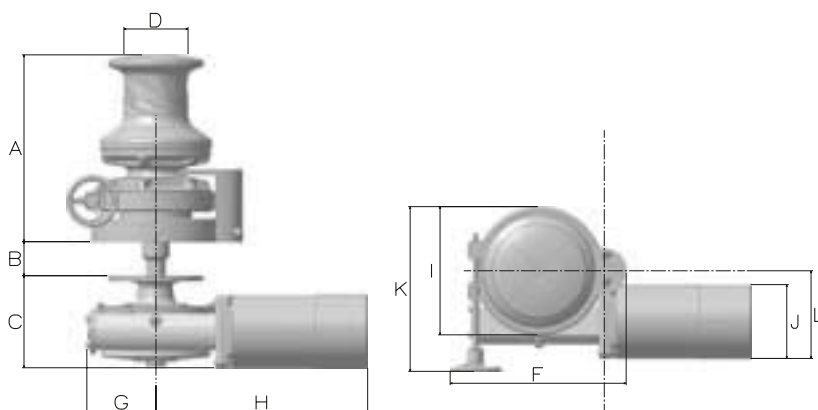

| Model | A | B | C | D | F | G | H | I | J | K | L |
|--------------|-----|-------|-----|------|-----|-----|-----|-----|------|-----|-----|
| 3000W | 385 | 60-90 | 200 | Ø132 | 365 | 152 | 449 | 264 | Ø152 | 339 | 190 |

* For Hydraulic version dimensions please see page 61

Erhältliches Zubehör

- Fußtaster
- Sicherungs-
automat
- Tastpaneel
- Kettenzähler
- Handfernbedienung
- Funkfern-
bedienung



www.lofrans.com

ERCOLE VERTICAL

3500W / 4000W / 5500W / Hydraulic - 11cc



| Construction | 316 L Stainless Steel | | | |
|------------------------------------|-----------------------|----------------------------------|---------|------------------|
| Motor size | 3500 W | 4000 W | 5500 W | Hydraulic - 11cc |
| Power Supply (V) | 24 | 230-400 | 230-400 | - |
| Maximum Pull (kg) | 4500 | 4500 | 5000 | 5000 |
| Working load (kg) | 1000 | 1000 | 1200 | 1200 |
| Amps at Working Load (A) | 240 | - | - | - |
| Line Speed at Working Load (m/min) | 12 | 13 | 13 | 14 |
| Max Line Speed (m/min) | 20 | 13 | 13 | 14 |
| Net Weight with Drum (kg) | 180 | 180 | 200 | 165 |
| Hydraulic Pressure (bar) | - | - | - | 200 |
| Hydraulic Flow (lt/min) | - | - | - | 40 |
| Control Box | Included in package | Switchboard available separately | | - |

| ERCOLE VERTICALE | Type** |
|------------------|-----------|
| With Drum | 14 mm cw |
| | 16 mm cw |
| | 14 mm ccw |
| | 16 mm ccw |

Alle Modelle auf Anfrage.

*Non-standard configuration optional gypsies can be supplied separately. Please refer to compatible gypsies table on next page.

** cw: the windlass pulls clockwise ccw: the windlass pulls counter clockwise

THE ORIGINAL WINDLASS



Hauptmerkmale sind:

- Kompakte Maße unter Deck
- Gehäuse aus handpoliertem "AISI" 316 L Edelstahl
- Hochleistungselektromotor speziell für den maritimen Bereich
- Bandbremse zur Feinjustierung mit extra großem Handrad
- Verholspill mit hoher Haltekraft, unabhängig von der Kettennuss einsetzbar
- Manuell Kettenablass möglich
- Handbetrieb im Notfall möglich
- Optimale Kettenführung, um das Deck nicht zu beschädigen
- Kettenzählwerkmontage als Option möglich
- Verschiedene Laufrichtungen
- Hochwertig gefertigte Getriebeeinheit aus speziellen, seewasserbeständigen Materialien
- Hochleistungsmotor
- Antrieb: Gleichstrom, Wechselstrom und hydraulischer Antrieb
- Custom made Versionen auf Anfrage möglich

Im Lieferumfang enthalten:

- bei 24 Volt Version Relais enthalten
- Kurbel
- Kettennuss
- CD mit Anleitung

Dimensions in mm

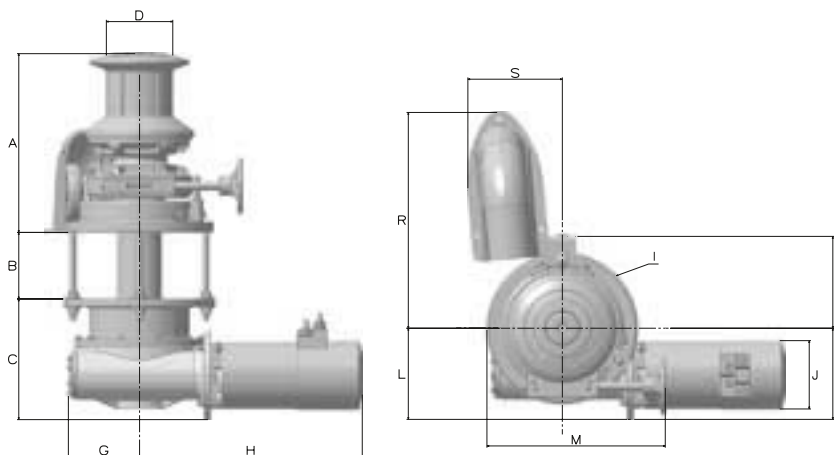

| Model | A | B | C | D | G | H | I | J | L | M | N | P | R | S |
|--------------|-----|-----|-----|-----|-----|-----|-----|------|-----|-----|-----|-----|-------------------|-------------------|
| 3500W | | | | | | | | | | | | | | |
| 4000W | 400 | 150 | 272 | 150 | 160 | 502 | 340 | Ø158 | 205 | 405 | 220 | 205 | min 490 - max 600 | min 200 - max 230 |
| 5500W | | | | | | | | | | | | | | |

* For Hydraulic version dimensions please see page 61

Lieferbare Ersatz-Kettennüsse



Best-Nr. Typ Kettennuss

| | |
|----------|--------------------------------|
| L 631019 | 10mm, ISO 4565 |
| L 631039 | 12mm, ISO 4565 / 13mm, DIN 766 |
| L 631065 | 14mm |
| L 631085 | 13mm. / DIN 764 |
| L 631082 | 16mm |
| L 631088 | 16mm, / DIN 766 |
| L 631101 | 18mm |
| L 631095 | 18mm, / DIN 766 |
| L 631113 | 20mm |

Wartungsskit

Bestell-Nr. Beschreibung

| | |
|----------|---------------------|
| L 418428 | KIT A - Dichtungen |
| L 418475 | KIT B - Schrauben |
| L 418499 | KIT C - Bolzen |
| L 418556 | KIT D - Sprengringe |

Erhältliches Zubehör

- Fußtaster
- Sicherungsautomat
- Tastpaneel
- Kettenzähler
- Handfernbedienung
- Funkfernbedienung



www.lofrans.com



HORIZONTAL

Horizontale Ankerwinden verfügen über eine horizontale Drehrichtung der Kettennuss und falls vorhanden des Verholspills. Der Elektromotor sowie das Getriebe sind durch ein Gehäuse geschützt und für Wartungsarbeiten zugänglich.

Zum Standard-Lieferumfang zählen:
Kurbel, Kettennuss, CD mit wichtigen Hinweisen und bei den elektrischen Modellen die passende Relais-Box.

Erhältliches Zubehör:
Taster, bzw. elektrischer Sicherungsautomat, Fernbedienung mit Kabel oder als Funkfernbedienung und Kettenzählwerk.



WINDLASSES

The range of horizontal windlasses is suitable for boats from 18 up to 150 feet offering the best in performance and functionality, when there is adequate deck space or if the chain locker has limited size or accessibility. They are simple, reliable, with their classic and timeless style making them perfect for many vessels, especially for the charter business.

Material and finish, marine grade aluminium alloy: Our horizontal anchor windlasses are produced using marine grade aluminium alloy. The body is polished and anodised. Most of the components are made by hot forging. The horizontal models are available as standard in anodized aluminium. Some models are available with a painted white polyester coating.

High performance motors: The horizontal windlasses' electric motors have been designed to supply high torque in all working conditions. They are available in 12 or 24 Volt DC current and 230-440 V three phase AC current. Most of the motors have an IP66 rating with a galvanized body painted with a polyester coating. Our electric motors are specified to provide the necessary power for long run time. They are also designed to operate at an increased speed and so reducing operating time. Titan, Ercole and Super Ercole are also available in hydraulic motor versions.

Lofrans gearboxes: Most of our horizontal windlasses use a Lofrans-made high efficiency worm screw gearbox. It is non-reversible with the gears produced with specific material able to withstand high-load strain. All gearboxes are oil lubricated in order to minimize working noise. The models for superior boats use a special Lofrans planetary - worm screw gearbox which allows them to have a high efficiency to dimension ratio.

Manual override: Most of the Lofrans horizontal windlasses are supplied with manual override which makes the windlass capable of chain recovery in the event of electrical failure. The manual override has the secondary function to provide a safety mechanism so that chain jams do not damage the deck.

Independent drum from the Gypsy: Horizontal models give the choice of utilizing the drum for warping operations independently from the Gypsy.

Automatic free fall: Models KOBRA and CAYMAN 88 can optionally have a device installed named AUTOMATIC FREE FALL. This device allows disengaging the clutch automatically by pushing the "Down" button of the remote control unit. Disengaging the clutch, the Gypsy rotates freely and the weight of the anchor releases the chain into the water.

Rope and chain management: Models DORADO and ATLAS are able to manage rope and chain by use of a special spring loaded tension arm called a finger, which pushes the rope deeply inside the Gypsy teeth.

CUSTOM PRODUCT: Models TITAN, ERCOLE and SUPER ERCOLE are available in six versions in order to meet all customer requirements.

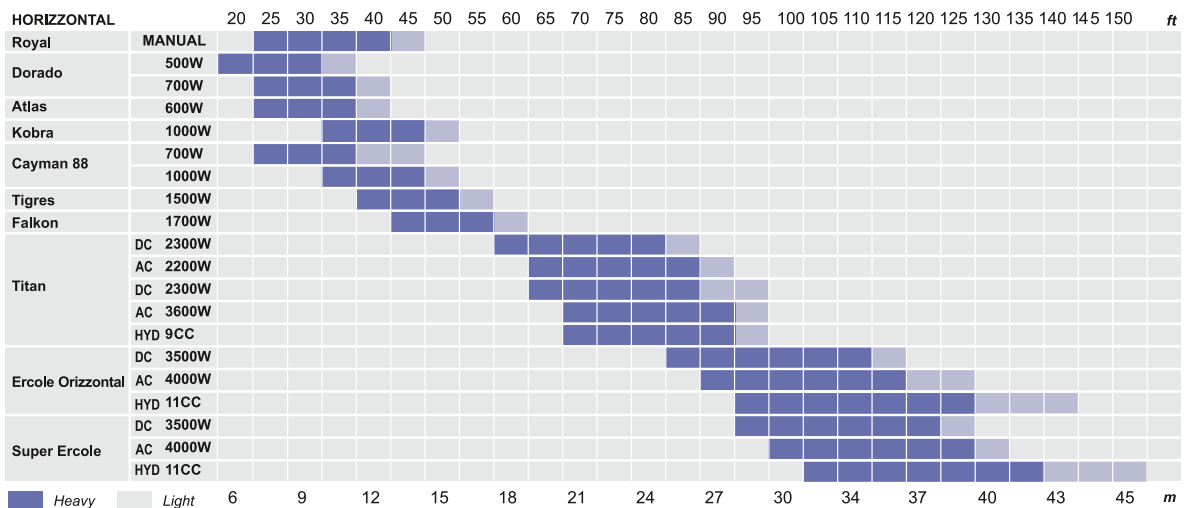

THE ORIGINAL WINDLASS



ROYAL - Horizontale Handankerwinde

Horizontal Windlass

Manual



Hauptmerkmale

- Gehäuse aus seewasserbeständigem Aluminium
- Wahlweise nur Kettennussantrieb oder mit Verholspill (Trommel)
- Freilauffunktion zum Ablassen der Kette
- Kettenablauf händisch steuerbar

Best-Nr.: Ausführung
LRYAA0001 ROYAL Handankerwinde

| | |
|------------------------------------|--------------------|
| Construction | Anodised Aluminium |
| Motor size | MANUAL |
| Power Supply (V) | - |
| Maximum Pull (kg) | 400 |
| Working load (kg) | 70 |
| Amps at Working Load (A) | - |
| Line Speed at Working Load (m/min) | - |
| Max Line Speed (m/min) | - |
| Net Weight with Drum (kg) | 10 |

| ROYAL |  |
|-----------|---|
| With Drum | 6 mm, ISO 4565 / DIN 766 |
| | 7 mm, ISO 4565 |
| | 8 mm, ISO 4565 / DIN 766 |
| | 10 mm, DIN 766 |
| | 10 mm, ISO 4565 |

Bitte die Kettennuss exakt angeben:
Wir benötigen die Größe und ob Sie DIN-, ISO- oder ZOLL - Kettennuss benötigen.

Lieferbare Ersatz-Kettennüsse



Best-Nr. Typ Kettennuss

| | |
|----------|--------------------------|
| L 630968 | 6 mm, ISO 4565 / DIN 766 |
| L 630978 | 7mm, ISO 4565 |
| L 630994 | 8 mm, ISO 4565 / DIN 766 |
| L 631118 | 10mm, DIN 766 |
| L 631011 | 10mm, ISO 4565 |
| L 631077 | 5/16 HT |
| L 631120 | 3/8 BBB |
| L 631122 | 3/8 PC |

Dimensions in mm

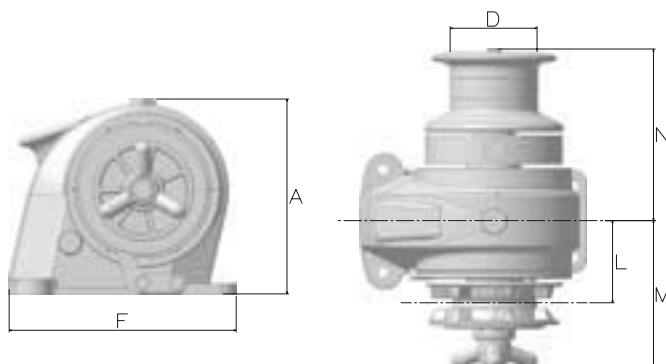

| Model | A | D | F | L | M | N |
|--------|-----|-----|-----|----|-----|-----|
| Manual | 192 | Ø85 | 222 | 80 | 145 | 167 |



Wartungskit
Bestell-Nr. L 72046

www.lofrans.com

DORADO - Horizontal Windlass

500W / 700W



Best-Nr.: Ausführung
LDRAA0512 DORADO / 12V / 500 W
LDRAA0712 DORADO / 12V / 700 W



NEU - Heckmontage-Einheit: Best-Nr.: L72204

Hauptmerkmale

- Gehäuse aus seewasserbeständigem Aluminium
- Freilauffunktion zum Ablassen der Kette
- Kettenmanagement durch Federarm
- IP66 wassergeschützte Motoreinheit
- Manueller Kettenablass möglich

Lieferbare Ersatz-Kettennüsse



Best-Nr. Typ Kettennuss

| | |
|----------|--------------------------|
| L 630974 | 6 mm, ISO 4565 / DIN 766 |
| L 630984 | 7mm, ISO 4565 |
| L 631003 | 8 mm, ISO 4565 / DIN 766 |

| Construction | Anodised Aluminium | |
|--|---------------------|---------|
| | 500 W | 700 W |
| Motor size | | |
| Power Supply (V) | 12 | 12 |
| Maximum Pull (kg) | 600 | 650 |
| Working load (kg) | 70 | 80 |
| Amps at Working Load (A) | 65 | 80 |
| Line Speed at Working Load (m/min) | 18 | 20 |
| Max Line Speed (m/min) | 24 | 25 |
| Net Weight Low Profile (kg) | 10 | 11 |
| Circuit Breaker (available separately) | L187331 | L187332 |
| Control Box | Included in package | |

| DORADO | | | Type |
|-------------|--------------------------|--------------------|------|
| Low Profile | 6 mm, ISO 4565 | 10-12 mm, 3-strand | Port |
| | 8 mm, ISO 4565 / DIN 766 | 12 mm, 3-strand | Port |

Bitte die Kettennuss exakt angeben: Wir benötigen die Größe und ob Sie DIN-, ISO- oder ZOLL - Kettennuss benötigen.

**Non-standard configuration optional gypsies can be supplied separately. Please refer to compatible gypsies table*

Dimensions in mm

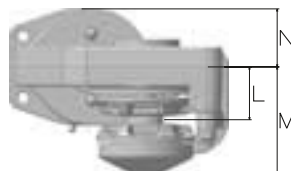

| Model | A | C | F | J | L | M | N |
|-------|-----|-----|-----|-----|----|----|----|
| 500W | 130 | 150 | 200 | Ø82 | 48 | 98 | 53 |
| 700W | 130 | 150 | 200 | Ø94 | 48 | 98 | 53 |

Erhältliches Zubehör

- Fußtaster
- Sicherungsautomat
- Tastpaneel
- Kettenzähler
- Handfernbedienung
- Funkfernbedienung



Wartungskit
Bestell-Nr. L 72047

THE ORIGINAL WINDLASS



ATLAS - Horizontal Windlass

600W



Hauptmerkmale

- Gehäuse aus seawasserbeständigem Aluminium
- Freilauffunktion zum Ablassen der Kette
- Kettenmanagement durch Federarm
- IP66 wassergeschützte Motoreinheit
- Manueller Kettenablass möglich

Lieferbare Ersatz-Kettennüsse



Best-Nr. Typ Kettennuss

| | |
|----------|--------------------------|
| L 631005 | 6 mm, ISO 4565 / DIN 766 |
| L 631007 | 7mm, ISO 4565 |
| L 631009 | 8 mm, ISO 4565 / DIN 766 |

Best-Nr.: Ausführung
LATLAS0612 ATLAS / 12V / 600 W (Gehäuse schwarz. Weiß auf Anfrage)

| Construction | Anodised Aluminium |
|---------------------------------------|--------------------|
| Motor size | 600 W |
| Power Supply (V) | 12 |
| Maximum Pull (kg) | 575 |
| Working load (kg) | 80 |
| Amps at Working Load (A) | 90 |
| Line Speed at Working Load (m/min) | 16 |
| Max Line Speed (m/min) | 28 |
| Net Weight Low Profile (kg) | 11 |
| Circuit Breaker (available separatly) | L187332 |
| Control Box | Built in |

| ATLAS | | |
|-------------|--------------------------|--------------------|
| Low Profile | 6 mm, ISO 4565 | 10-12 mm, 3-strand |
| | 7 mm, ISO 4565 | 12 mm, 3-strand |
| | 8 mm, ISO 4565 / DIN 766 | 12 mm, 3-strand |

Bitte die Kettennuss exakt angeben: Wir benötigen die Größe und ob Sie DIN-, ISO- oder ZOLL - Kettennuss benötigen.

*Non-standard configuration optional gypsies can be supplied separately.
Please refer to compatible gypsies table

Dimensions in mm

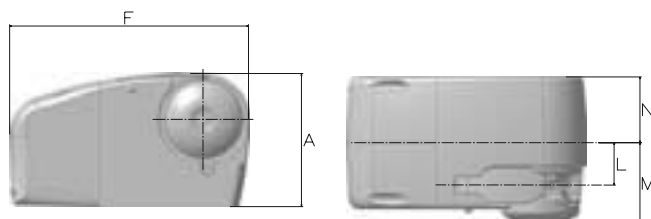

| Model | A | F | L | M | N |
|-------|-----|-----|----|----|----|
| 600W | 153 | 272 | 50 | 93 | 75 |

Erhältliches Zubehör

- Fußtaster
- Sicherungsautomat
- Tastpaneel
- Kettenzähler
- Handfernbedienung
- Funkfernbedienung



Wartungskit
Bestell-Nr. L 72045

www.lofrans.com

CAYMAN - Horizontal Windlass

700W / 1000W



Hauptmerkmale für CAYMAN und KOBRA

- Gehäuse aus seewasserbeständigem Aluminium
- Unabhängige Kettennuss und Verholspillfunktion
- Freilauffunktion zum Ablassen der Kette
- IP66 wassergeschützte Motoreinheit
- Manueller Kettenablass möglich

Best-Nr.: Ausführung
LCMAA1012 CAYMAN / 12V / 1000 W
LCMAA1024 CAYMAN / 24V / 1000 W

700 W-Version auf Anfrage.

| Construction | Anodised Aluminium | | |
|--|---------------------|---------|---------|
| | 700 W | 1000 W | |
| Motor size | | | |
| Power Supply (V) | 12 | 12 | 24 |
| Maximum Pull (kg) | 1000 | 1250 | 1325 |
| Working load (kg) | 100 | 170 | 170 |
| Amps at Working Load (A) | 110 | 150 | 80 |
| Line Speed at Working Load (m/min) | 21 | 16 | 17 |
| Max Line Speed (m/min) | 32 | 32 | 33 |
| Net Weight with Drum (kg) | 24 | 25 | 25 |
| Circuit Breaker (available separately) | L187332 | L187333 | L187332 |
| Control Box | Included in package | | |

Erhältliches Zubehör

- Fußtaster
 - Sicherheitsautomat
 - Tastpaneel
 - Kettenzähler
 - Handfernbedienung
 - Funkfernbedienung
-

| CAYMAN | |
|-----------|--------------------------|
| With Drum | 6 mm, ISO 4565 / DIN 766 |
| | 8 mm, ISO 4565 / DIN 766 |
| | 10 mm, ISO 4565 |
| | 10 mm, DIN 766 |

Bitte die Kettennuss exakt angeben:
 Wir benötigen die Größe und ob Sie DIN-, ISO- oder ZOLL - Kettennuss benötigen.

*Non-standard configuration optional gypsies can be supplied separately.
 Please refer to compatible gypsies table

Dimensions in mm

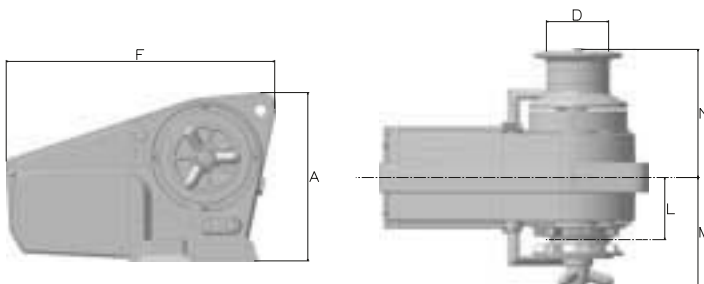

| Model | A | D | F | L | M | N |
|-------|-----|-----|-----|----|-----|-----|
| 700W | 230 | Ø85 | 370 | 85 | 150 | 175 |
| 1000W | 230 | Ø85 | 370 | 85 | 150 | 175 |

THE ORIGINAL WINDLASS



KOBRA - Horizontal Windlass

1000W

Lieferbare Ersatz-
Kettennüsse für beide
Modelle



Best-Nr. Typ Kettennuss

| | |
|----------|--------------------------|
| L 630968 | 6 mm, ISO 4565 / DIN 766 |
| L 630978 | 7 mm, ISO 4565 |
| L 630994 | 8 mm, ISO 4565 / DIN 766 |
| L 631118 | 10 mm, / DIN 766 |
| L 631011 | 10 mm, ISO 4565 |
| L 631120 | 3/8 BBB |
| L 631122 | 3/8 PC |
| L 631077 | 5/16 HT |

**KEEP YOUR LOFRANS'
AS GOOD AS NEW!**



Wartungskit für beide Modelle
Bestell-Nr. L 72048



Best-Nr.: Ausführung
LKBAA1012 KOBRA / 12V / 1000 W
LKBAA1024 KOBRA / 24V / 1000 W

| Construction | Anodised Aluminium | |
|--|---------------------|---------|
| Motor size | 1000 W | |
| Power Supply (V) | 12 | 24 |
| Maximum Pull (kg) | 1250 | 1325 |
| Working load (kg) | 170 | 170 |
| Amps at Working Load (A) | 150 | 80 |
| Line Speed at Working Load (m/min) | 16 | 17 |
| Max Line Speed (m/min) | 32 | 33 |
| Net Weight with Drum (kg) | 21 | 21 |
| Circuit Breaker (available separately) | L187333 | L187332 |
| Control Box | Included in package | |

| KOBRA |  |
|-----------|---|
| With Drum | 6 mm, ISO 4565 / DIN 766 |
| | 8 mm, ISO 4565 / DIN 766 |
| | 10 mm, DIN 766 |
| | 10 mm, ISO 4565 |

Bitte die Kettennuss exakt angeben:
Wir benötigen die Größe und ob Sie DIN-,
ISO- oder ZOLL - Kettennuss benötigen.

**Non-standard configuration optional gypsies can be supplied separately.
Please refer to compatible gypsies table*

Dimensions in mm

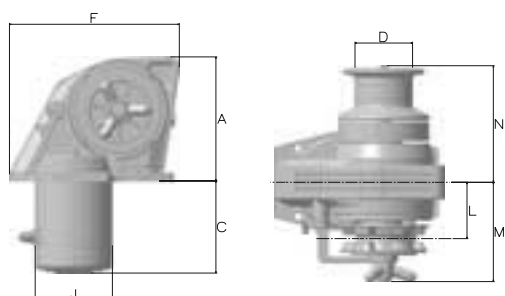

| Model | A | C | F | D | J | L | M | N |
|-------|-----|-----|-----|-----|------|----|-----|-----|
| 1000W | 184 | 136 | 250 | Ø85 | Ø114 | 83 | 147 | 172 |

www.lofrans.com

TIGRES - Horizontal Windlass

1500W



Best-Nr.: Ausführung
LTGAA1512 TIGRES / 12V / 1500 W
LTGAA1524 TIGRES / 24V / 1500 W

Hauptmerkmale

- Gehäuse aus seewasserbeständigem Aluminium
- Unabhängige Kettennuss und Verholspiffunktion
- Freilauffunktion zum Ablassen der Kette
- IP66 wassergeschützte Motoreinheit
- Manueller Kettenablass möglich
- Alusilber Standard - Weiß auf Anfrage

Lieferbare Ersatz-Kettennüsse



Best-Nr. Typ Kettennuss

| | |
|----------|--------------------------|
| L 630968 | 6 mm, ISO 4565 / DIN 766 |
| L 630978 | 7mm, ISO 4565 |
| L 630994 | 8 mm, ISO 4565 / DIN 766 |
| L 631118 | 10 mm, / DIN 766 |
| L 631011 | 10 mm, ISO 4565 |
| L 631120 | 3/8 BBB |
| L 631122 | 3/8 PC |
| L 631077 | 5/16 HT |

| Construction | Anodised Aluminium | |
|--|---------------------|---------|
| Motor size | 1500 W | |
| Power Supply (V) | 12 | 24 |
| Maximum Pull (kg) | 1350 | 1400 |
| Working load (kg) | 195 | 195 |
| Amps at Working Load (A) | 160 | 90 |
| Line Speed at Working Load (m/min) | 14 | 16 |
| Max Line Speed (m/min) | 33 | 33 |
| Net Weight with Drum (kg) | 28 | 28 |
| Circuit Breaker (available separately) | L187333 | L187332 |
| Control Box | Included in package | |

| TIGRES | |
|-----------|--------------------------|
| With Drum | 8 mm, ISO 4565 / DIN 766 |
| | 10 mm, DIN 766 |
| | 10 mm, ISO 4565 |

Bitte die Kettennuss exakt angeben:
 Wir benötigen die Größe und ob Sie DIN-, ISO- oder ZOLL - Kettennuss benötigen.

**Non-standard configuration optional gypsies can be supplied separately.
 Please refer to compatible gypsies table*

Dimensions in mm

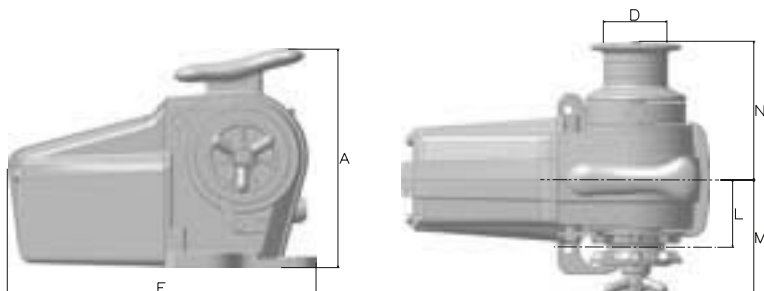

| Model | A | D | F | L | M | N |
|-------|-----|-----|-----|----|-----|-----|
| 1500W | 290 | Ø85 | 415 | 90 | 155 | 185 |

THE ORIGINAL WINDLASS

Erhältliches Zubehör

- Fußtaster
- Sicherungsautomat
- Tastpaneel
- Kettenzähler
- Handfernbedienung
- Funkfernbedienung



Wartungsset
Bestell-Nr. L 72050



FALKON - Horizontal Windlass

1700W



Best-Nr.: Ausführung
LFKAA1712 FALKON
 12V / 1700 W
LFKAA1724 FALKON
 24V / 1700 W

| Construction | Anodised Aluminium | |
|--|---------------------|---------|
| Motor size | 1700 W | |
| Power Supply (V) | 12 | 24 |
| Maximum Pull (kg) | 1700 | 1800 |
| Working load (kg) | 290 | 290 |
| Amps at Working Load (A) | 210 | 100 |
| Line Speed at Working Load (m/min) | 14 | 15 |
| Max Line Speed (m/min) | 33 | 33 |
| Net Weight with Drum (kg) | 55 | 55 |
| Circuit Breaker (available separately) | L187334 | L187332 |
| Control Box | Included in package | |

| FALKON |  |
|-----------|---|
| | 10 mm, DIN 766 |
| With drum | 10 mm, ISO 4565 |
| | 12mm ISO 4565 / 13mm DIN 766 |

Bitte die Kettennuss exakt angeben:
 Wir benötigen die Größe und ob Sie DIN-, ISO- oder ZOLL - Kettennuss benötigen.

**Non-standard configuration optional gypsies can be supplied separately.
 Please refer to compatible gypsies table*

Dimensions in mm

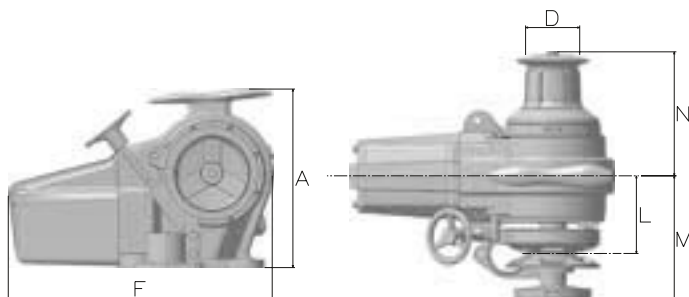

| Model | A | D | F | L | M | N |
|-------|-----|------|-----|-----|-----|-----|
| 1700W | 340 | Ø104 | 500 | 147 | 240 | 235 |

Hauptmerkmale

- Gehäuse aus seewasserbest. Aluminium
- Unabh. Kettennuss und Verholspiffunktion
- Freilauffunktion zum Ablassen der Kette
- IP66 wassergeschützte Motoreinheit
- Manueller Kettenablass möglich
- Alusilber Standard - Weiß auf Anfrage

Lieferbare Ersatz-Kettennüsse



Best-Nr. Typ Kettennuss

| | |
|----------|--------------------------------|
| L 630996 | 8 mm, ISO 4565 / DIN 766 |
| L 631132 | 10 mm, / DIN 766 |
| L 631022 | 10 mm, ISO 4565 |
| L 631031 | 12mm, ISO 4565 / 13mm, DIN 766 |
| L 631050 | 13mm, / DIN 764 |
| L 631059 | 14mm |
| L 631033 | 1/2" BBB |
| L 631036 | 1/2" G40 |
| L 631124 | 3/8" G40 |
| L 631129 | 5/16" HT |
| L 630992 | 7/16" HT |

Erhältliches Zubehör

- Fußtaster
- Sicherungsautomat
- Tastpaneel
- Kettenzähler
- Handfernbedienung
- Funkfernbedienung



Wartungskit
Bestell-Nr. L 72051

www.lofrans.com

TITAN - Horizontal Windlass

2300W / 3600W / Hydraulic



Hauptmerkmale

- Gehäuse aus seewasserbeständigem Aluminium
- Unabhängige Kettennuss und Verholspillfunktion
- Freilauffunktion zum Ablassen der Kette
- IP66 wassergeschützte Motoreinheit
- Manueller Kettenablass möglich
- Alusilber Standard - Weiß auf Anfrage

Type B - White Aluminium

| Construction | Anodised Aluminium | | White Aluminium | Anodised Aluminium |
|--|---------------------|----------------------------------|-----------------|--------------------|
| Motor size | 2300 W | 3600 W | 3600 W | Hydraulic - 9cc |
| Power Supply (V) | 24 | 230-400 | 230-400 | - |
| Maximum Pull (kg) | 2800 | 2800 | 2800 | 3400 |
| Working load (kg) | 550 | 650 | 650 | 700 |
| Amps Work Load (A) | 140 | - | - | - |
| Amps at Working Load (A) | 10 | 11 | 11 | 11 |
| Line Speed at Working Load (m/min) | 18 | 11 | 11 | 11 |
| Net Weight with Drum (kg) | 115 | 115 | 115 | 95 |
| Hydraulic Pressure (bar) | - | - | - | 200 |
| Hydraulic Flow (lt/min) | - | - | - | 32 |
| Circuit Breaker (available separately) | L187333 | - | - | - |
| Control Box | Included in package | Switchboard available separately | | - |

| TITAN |  | Model** |
|-----------|---|---------|
| With Drum | 12 mm, ISO 4565 / 13mm, DIN 766 | Type A |
| | | |
| | 12 mm, ISO 4565 / 13mm, DIN 766 | Type B |
| | | |

Diese Modelle bitte einzeln bei uns anfragen.

****Available also in Type C, D...**

**Non-standard configuration optional gypsies can be supplied separately. Please refer to compatible gypsies table*

THE ORIGINAL WINDLASS

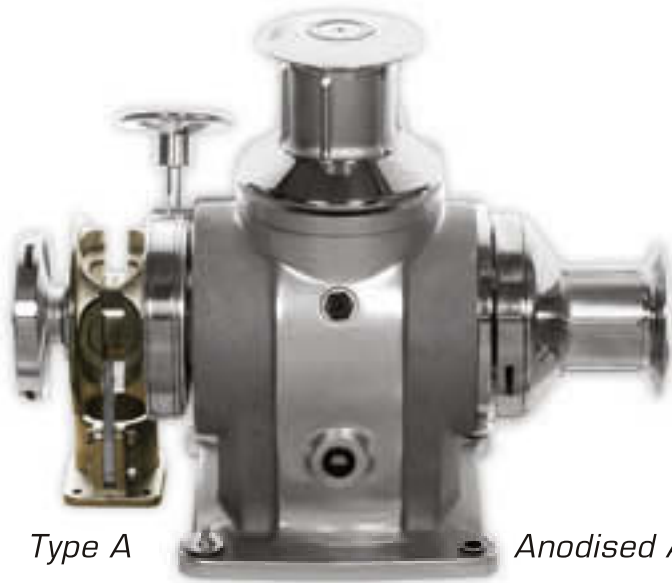

Type A

Anodised Aluminium

**Lieferbare
Ersatz-Kettennüsse**



Best-Nr. Typ Kettennuss

| | |
|----------|--------------------------------|
| L 630996 | 8 mm, ISO 4565 / DIN 766 |
| L 631132 | 10 mm, / DIN 766 |
| L 631013 | 10 mm, ISO 4565 |
| L 631031 | 12mm, ISO 4565 / 13mm, DIN 766 |
| L 631059 | 14mm |
| L 631033 | 1/2" BBB |
| L 631036 | 1/2" G40 |
| L 631124 | 3/8" G40 |

Dimensions in mm

Type A

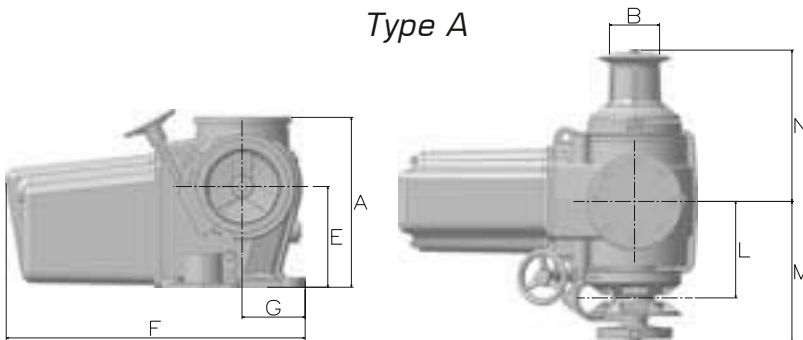

| Model | A | C | F | D | J | L | M | N |
|-----------|-----|------|-----|-----|-----|-----|-----|-----|
| 2300W | 330 | Ø104 | 193 | 590 | 120 | 185 | 270 | 290 |
| 3600W | | | | | | | | |
| Hydraulic | | | | | | | | |

Type B

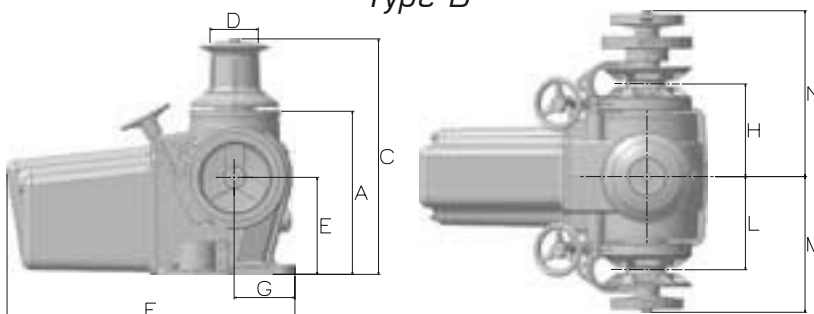

| Model | A | C | D | E | F | G | H | L | M | N |
|-----------|-----|-----|------|-----|-----|-----|-----|-----|-----|-----|
| 2300W | 330 | 465 | Ø104 | 193 | 590 | 120 | 185 | 185 | 270 | 290 |
| 3600W | | | | | | | | | | |
| Hydraulic | | | | | | | | | | |

Wartungskit

Bestell-Nr. Beschreibung

| | |
|----------|---------------------|
| L 418403 | KIT A - Dichtungen |
| L 418457 | KIT B - Schrauben |
| L 418493 | KIT C - Bolzen |
| L 418553 | KIT D - Sprengringe |

Erhältliches Zubehör

- Fußtaster
- Sicherungsautomat
- Tastpaneel
- Kettenzähler
- Handfernbedienung
- Funkfernbedienung
- Kettenstopper



ERCOLE - Horizontal Windlass

3500W / 4000W / Hydraulic

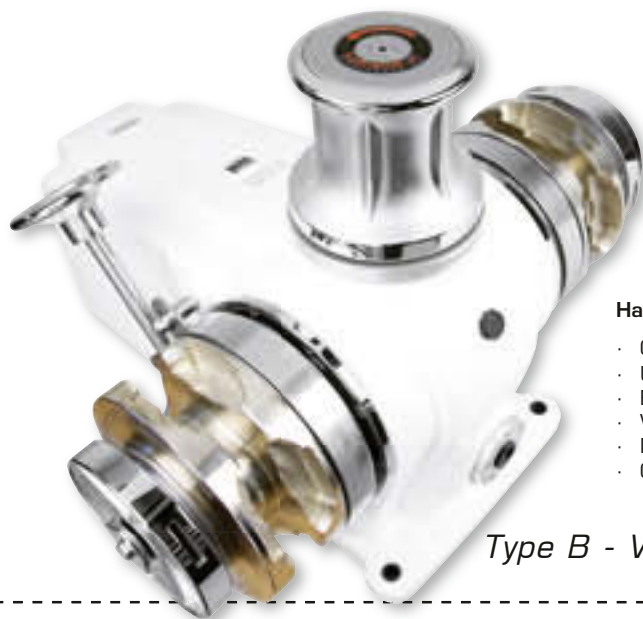

Hauptmerkmale

- Gehäuse aus seewasserbeständigem Aluminium
- Unabhängige Kettennuss und Verholspillfunktion
- Freilauffunktion zum Ablassen der Kette
- Wassergeschützte Motoreinheit
- Manueller Kettenablass möglich
- Gehäuse weiß pulverbeschichtet

Type B - White Aluminium



Chain pipe included

| Construction | White Aluminium | |
|------------------------------------|---------------------|------------------|
| | 3500 W | Hydraulic - 11cc |
| Motor size | 3500 W | Hydraulic - 11cc |
| Power Supply (V) | 24 | - |
| Maximum Pull (kg) | 4500 | 5000 |
| Working load (kg) | 1000 | 1200 |
| Amps at Working Load (A) | 240 | - |
| Line Speed at Working Load (m/min) | 12 | 14 |
| Max Line Speed (m/min) | 20 | 14 |
| Net Weight with Drum (kg) | 200 | 180 |
| Hydraulic Pressure (bar) | - | 200 |
| Hydraulic Flow (lt/min) | - | 40 |
| Control Box | Included in package | |

| ERCOLE | | Model |
|-----------|-------|--------|
| With Drum | 14 mm | Type A |
| | | Type B |
| | | Type C |

Diese Modelle bitte einzeln bei uns anfragen.

****Available also in Type D, E, F**

**Non-standard configuration optional gypsies can be supplied separately. Please refer to compatible gypsies table*

THE ORIGINAL WINDLASS



Dimensions in mm

Type A

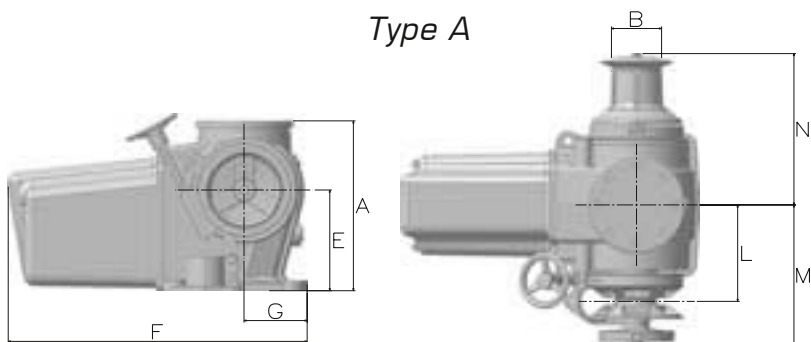

| Model | A | B | E | F | G | L | M | N |
|--------------|-----|------|-----|-----|-----|---------|-----|-----|
| 3500W | 390 | Ø150 | 230 | 705 | 160 | 230-250 | 390 | 340 |
| Hydraulic | | | | | | | | |

Type B

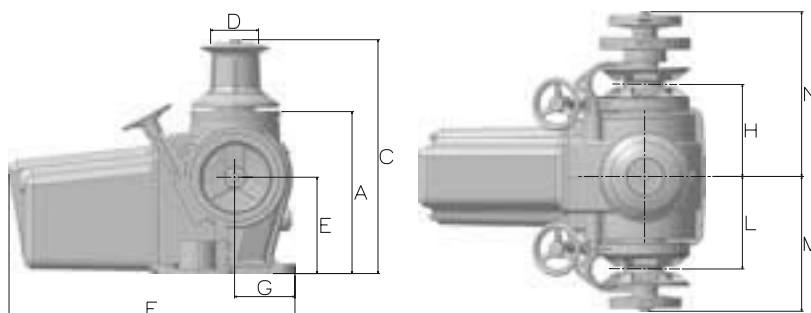

| Model | A | C | D | E | F | G | H | L | M | N |
|--------------|-----|-----|------|-----|-----|-----|---------|---------|-----|-----|
| 3500W | 390 | 555 | Ø125 | 230 | 705 | 160 | 230-250 | 230-250 | 390 | 340 |
| Hydraulic | | | | | | | | | | |

Type C

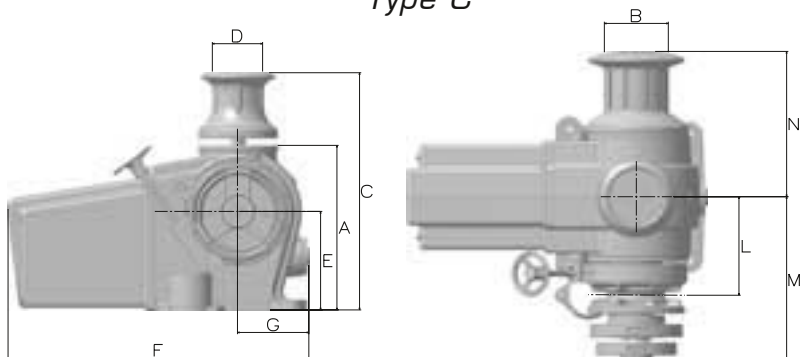

| Model | A | B | C | D | E | F | G | L | M | N |
|--------------|-----|------|-----|------|-----|-----|-----|---------|-----|-----|
| 2300W | 390 | Ø150 | 555 | Ø125 | 230 | 705 | 170 | 230-250 | 390 | 339 |
| Hydraulic | | | | | | | | | | |

Lieferbare Ersatz-Kettennüsse



Best-Nr. Typ Kettennuss

| | |
|----------|--------------------------------|
| L 631019 | 10mm, ISO 4565 |
| L 631039 | 12mm, ISO 4565 / 13mm, DIN 766 |
| L 631065 | 14mm |
| L 631085 | 13mm. / DIN 764 |
| L 631082 | 16mm |
| L 631088 | 16mm, / DIN 766 |
| L 631101 | 18mm |
| L 631095 | 18mm, / DIN 766 |
| L 631113 | 20mm |

Wartungskit

Bestell-Nr. Beschreibung

| | |
|----------|---------------------|
| L 418423 | KIT A - Dichtungen |
| L 418472 | KIT B - Schrauben |
| L 418494 | KIT C - Bolzen |
| L 418555 | KIT D - Sprengringe |

Erhältliches Zubehör

- Fußtaster
- Sicherheitsautomat
- Tastpaneel
- Kettenzähler
- Handfernbedienung
- Funkfernbedienung
- Kettenstopper



www.lofrans.com

SUPER ERCOLE



Hauptmerkmale

- Gehäuse aus seewasserbeständigem Aluminium
- Unabhängige Kettennuss und Verholspillfunktion
- Freilauffunktion zum Ablassen der Kette
- Wassergeschützte IP44 Motoreinheit
- Manueller Kettenablass möglich
- Gehäuse weiß pulverbeschichtet

Type B - White Aluminium

| Construction | White Aluminium | | |
|------------------------------------|---------------------|----------------------------------|------------------|
| | 3500 W | 5500 W | Hydraulic - 11cc |
| Motor size | 3500 W | 5500 W | Hydraulic - 11cc |
| Power Supply (V) | 24 | 230-400 | - |
| Maximum Pull (kg) | 5000 | 5500 | 6500 |
| Working load (kg) | 950 | 1200 | 1500 |
| Amps at Working Load (A) | 240 | - | - |
| Line Speed at Working Load (m/min) | 14 | 17 | 18 |
| Max Line Speed (m/min) | 28 | 17 | 18 |
| Net Weight with Drum (kg) | 235 | 235 | 215 |
| Hydraulic Pressure (bar) | - | - | 200 |
| Hydraulic Flow (lt/min) | - | - | 40 |
| Control Box | Included in package | Switchboard available separately | - |

| SUPER ERCOLE |  | Model |
|--------------|---|--------|
| With Drum | 16 mm | Type A |
| | | Type B |

Diese Modelle bitte einzeln bei uns anfragen.

****Available also in Type C, D, E, F**

**Non-standard configuration optional gypsies are supply separately. Please refer to compatible gypsies table on next page.*

THE ORIGINAL WINDLASS



- Horizontal Windlass

3500W / 5500W / Hydraulic



Dimensions in mm

Type A

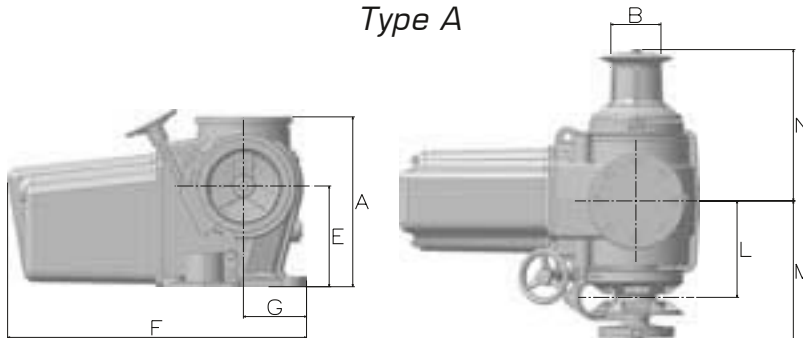

| Model | A | C | F | D | J | L | M | N |
|-----------|-----|------|-----|-----|-----|-----|-----|-----|
| 2300W | 330 | Ø104 | 193 | 590 | 120 | 185 | 270 | 290 |
| 3600W | | | | | | | | |
| Hydraulic | | | | | | | | |

Type B

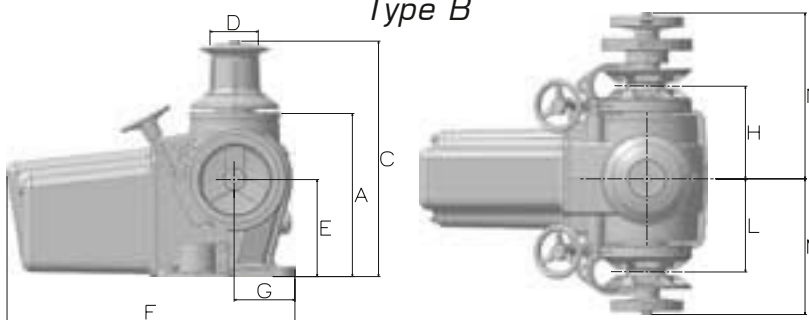

| Model | A | C | D | E | F | G | H | L | M | N |
|-----------|-----|-----|------|-----|-----|-----|-----|-----|-----|-----|
| 2300W | 330 | 465 | Ø104 | 193 | 590 | 120 | 185 | 185 | 270 | 290 |
| 3600W | | | | | | | | | | |
| Hydraulic | | | | | | | | | | |

Lieferbare Ersatz-Kettennüsse



Best-Nr. Typ Kettennuss

| | |
|----------|--------------------------------|
| L 631019 | 10mm, ISO 4565 |
| L 631039 | 12mm, ISO 4565 / 13mm, DIN 766 |
| L 631065 | 14mm |
| L 631085 | 13mm. / DIN 764 |
| L 631082 | 16mm |
| L 631088 | 16mm, DIN 766 |
| L 631101 | 18mm |
| L 631095 | 18mm, DIN 766 |
| L 631113 | 20mm |

Wartungskit

Bestell-Nr. Beschreibung

| | |
|----------|---------------------|
| L 427806 | KIT A - Dichtungen |
| L 418476 | KIT B - Schrauben |
| L 418500 | KIT C - Bolzen |
| L 418575 | KIT D - Sprengringe |

Erhältliches Zubehör

- Fußtaster
- Sicherungsautomat
- Tastpaneel
- Kettenzähler
- Handfernbedienung
- Funkfernbedienung
- Kettenstopper



www.lofrans.com

CAPSTANS



The range of Lofrans capstans is designed for boats from 18 up to 150 feet. Capstans are normally installed on the stern of the boat for mooring operations and are used in recreational, fishing and commercial vessels.

They are normally installed on the vessel in addition to the anchor windlass, with the number of capstan units depending on the length and displacement of the vessel.

They are controlled by a pair of the foot switches close to the capstan, so that the operator can have his/her hands free for rope handling.

The construction is very similar to our vertical windlass range using the same mechanical components, giving strength and high performance by relying on Lofrans'- made worm screw gearbox.

The base is manufactured using chromed bronze, strong and long lasting, as are the drums, which have the proper surface to hold the rope and minimize wear.

Models T3000 and T4000 have base and drum in mirror polished AISI 316L stainless steel and the main structure of the gearbox is of a strong single-block construction, same as our big vertical anchor windlasses for vessels of superior dimension.

Available to operate with 12V DC, 24V DC as well as AC or hydraulic motors for the larger size/higher power models, they are designed to meet a wide range of user requirements.

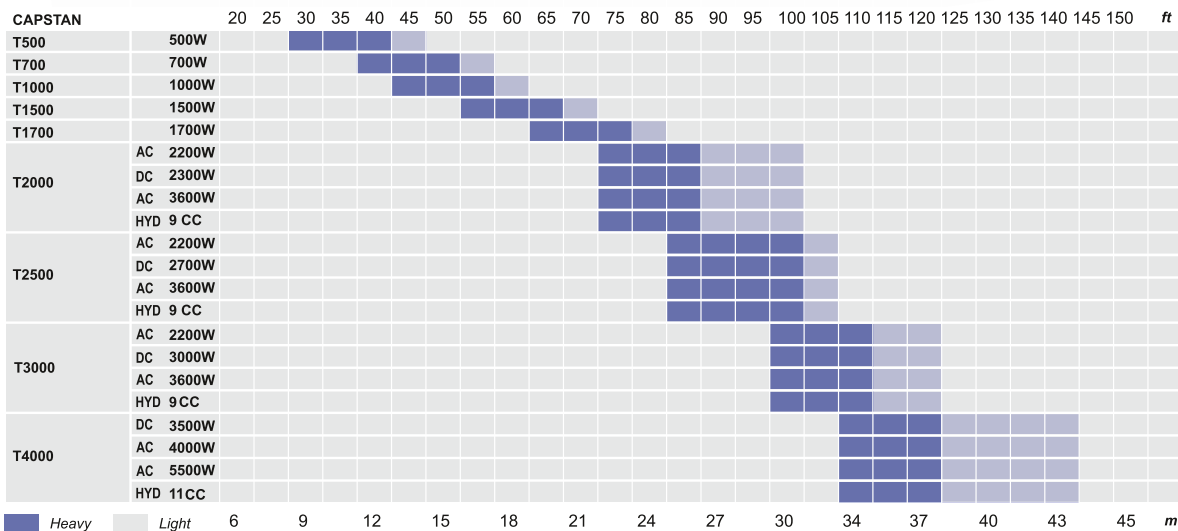

THE ORIGINAL WINDLASS



T500-T700-T1000 - Capstan

Main features

- Luxury chrome bronze base and drum
- Heavy duty rated IP67 electric motor
- Anodised marine aluminium gearbox



Chromed Bronze

| Construction | Chromed bronze | | | | | Aluminium | | | | |
|--|---------------------|---------|---------|---------|---------|-----------|---------|---------|---------|---------|
| | T500 | T700 | | T1000 | | T500 | T700 | | T1000 | |
| Motor size | 500 W | 700 W | | 1000 W | | 500 W | 700 W | | 1000 W | |
| Power Supply (V) | 12 | 12 | 24 | 12 | 24 | 12 | 12 | 24 | 12 | 24 |
| Maximum Pull (kg) | 630 | 850 | 900 | 1000 | 1060 | 630 | 850 | 900 | 1000 | 1060 |
| Working load (kg) | 70 | 115 | 115 | 165 | 165 | 70 | 115 | 115 | 165 | 165 |
| Amps at Working Load (A) | 75 | 110 | 50 | 135 | 70 | 75 | 110 | 50 | 135 | 70 |
| Line Speed at Working Load (m/min) | 23 | 20 | 23 | 20 | 23 | 23 | 20 | 23 | 20 | 23 |
| Max Line Speed (m/min) | 26 | 30 | 30 | 40 | 40 | 26 | 30 | 30 | 40 | 40 |
| Net Weight with Drum (kg) | 11 | 15 | 15 | 21 | 21 | 9 | 15 | 15 | 16 | 16 |
| Circuit Breaker (available separately) | L187331 | L187331 | L187332 | L187333 | L187332 | L187331 | L187331 | L187332 | L187333 | L187332 |
| Control Box | Included in package | | | | | | | | | |

Dimensions in mm

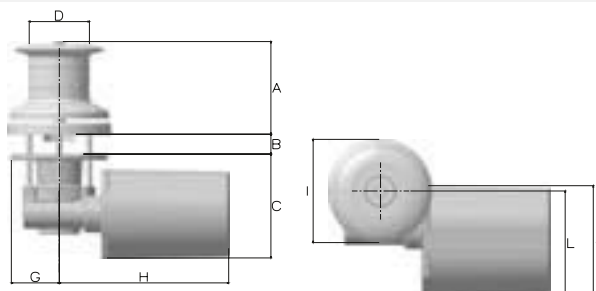

| Model | A | B | C | D | G | H | I | J | L |
|-------|-----|-------|-----|-----|----|-----|------|-----|-----|
| T500 | 90 | 18-30 | 111 | Ø60 | 55 | 236 | Ø115 | 110 | 121 |
| T700 | 135 | 25-40 | 150 | Ø92 | 62 | 256 | Ø155 | 134 | 157 |
| T1000 | 135 | 25-40 | 150 | Ø92 | 62 | 256 | Ø155 | 134 | 157 |

Alle CAPSTAN Modelle bitte einzeln bei uns anfragen.



T1500-T1700 - Capstan



Aluminium

IP67 rated heavy duty electric motor (T1500)

| Construction | Chromed bronze | | | | Aluminium | | | |
|---------------------------------------|---------------------|---------|---------|---------|-----------|---------|---------|---------|
| | T1500 | | T1700 | | T1500 | | T1700 | |
| Model | 1500 W | | 1700 W | | 1500 W | | 1700 W | |
| Motor size | 1500 W | | 1700 W | | 1500 W | | 1700 W | |
| Power Supply (V) | 12 | 24 | 12 | 24 | 12 | 24 | 12 | 24 |
| Maximum Pull (kg) | 1200 | 1250 | 1600 | 1695 | 1200 | 1250 | 1600 | 1695 |
| Working load (kg) | 190 | 190 | 270 | 270 | 190 | 190 | 270 | 270 |
| Amps at Working Load (A) | 150 | 75 | 180 | 90 | 150 | 75 | 180 | 90 |
| Line Speed at Working Load (m/min) | 17 | 19 | 14 | 15 | 17 | 19 | 14 | 15 |
| Max Line Speed (m/min) | 40 | 40 | 32 | 32 | 40 | 40 | 32 | 32 |
| Net Weight with Drum (kg) | 27 | 27 | 30 | 30 | 18 | 18 | 25 | 25 |
| Circuit Breaker (available separatly) | L187333 | L187332 | L187334 | L187332 | L187333 | L187332 | L187334 | L187332 |
| Control Box | Included in package | | | | | | | |

Dimensions in mm

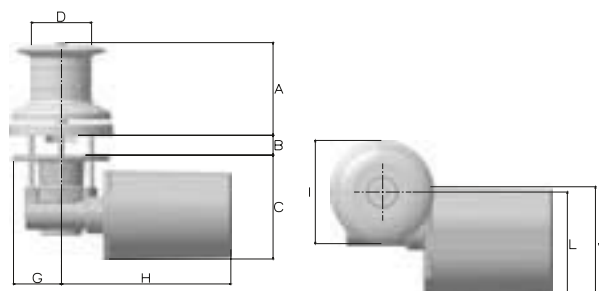

| Model | A | B | C | D | G | H | I | J | L |
|-------|-----|-------|-----|------|----|-----|------|------|-----|
| T1500 | 162 | 50-70 | 160 | Ø104 | 73 | 236 | Ø191 | 165 | 157 |
| T1700 | 162 | 50-70 | 165 | Ø104 | 90 | 300 | Ø191 | Ø127 | 140 |

THE ORIGINAL WINDLASS

Alle CAPSTAN Modelle bitte einzeln bei uns anfragen.



T2000-T2500 - Capstan



Main features

- Luxury chrome bronze base and drum
- Heavy duty electric motor
- Anodised marine aluminium gearbox



| Construction | Chromed bronze | | | | | | | |
|------------------------------------|----------------------------------|---------------------|------|-----------------|-----------------|----------------------------------|---------------------|---|
| | T2000 | | | | T2500 | | | |
| Model | 2200 W | | | 2300 W | Hydraulic - 9cc | 2700 W | | |
| Motor size | 2200 W | 2300 W | | Hydraulic - 9cc | 2200 W | 2700 W | Hydraulic - 9cc | |
| Type** | cw | cw | ccw | cw | cw | cw | cw | |
| Power Supply (V) | 230-400 | 24 | 24 | - | 230-400 | 24 | - | |
| Maximum Pull (kg) | 2000 | 2000 | 2000 | 2300 | 2000 | 2200 | 2300 | |
| Working load (kg) | 410 | 410 | 410 | 510 | 425 | 425 | 550 | |
| Amps at Working Load (A) | - | 180 | 180 | - | - | 210 | - | |
| Line Speed at Working Load (m/min) | 15 | 15 | 15 | 15 | 15 | 15 | 15 | |
| Max Line Speed (m/min) | 15 | 31 | 31 | 15 | 15 | 31 | 15 | |
| Net Weight with Drum (kg) | 52 | 52 | 52 | 40 | 52 | 53 | 40 | |
| Hydraulic Pressure (bar) | - | - | - | 200 | - | - | 200 | |
| Hydraulic Flow (lt/min) | - | - | - | 32 | - | - | 32 | |
| Control Box | Switchboard available separately | Included in package | | | - | Switchboard available separately | Included in package | - |

** cw: the capstan pulls clockwise ccw: the capstan pulls counter clockwise

Dimensions in mm

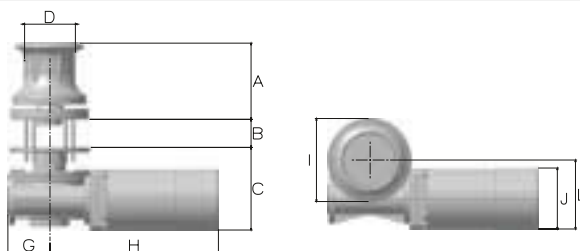

| Model | A | B | C | D | G | H | I | J | L |
|-------|-----|--------|-----|------|-----|-----|------|------|-----|
| T2000 | 190 | 60-90 | 212 | Ø125 | 105 | 420 | Ø194 | Ø152 | 176 |
| T2500 | 191 | 90-130 | 212 | Ø125 | 105 | 420 | Ø230 | Ø152 | 172 |

Alle CAPSTAN Modelle bitte einzeln bei uns anfragen.

T3000-T4000 - Capstan



Main features

- Luxury stainless steel base and drum
- Heavy duty electric motor
- Anodised marine aluminium gearbox



| Construction | 316 L Stainless Steel | | | | | | |
|------------------------------------|----------------------------------|---------------------|----------------------------------|-----------------|---------------------|----------------------------------|---------|
| Model | T3000 | | | | T4000 | | |
| Motor size | 2200 W | 3000 W | 3600 W | Hydraulic - 9cc | 3500 W | 4000 W | 5500 W |
| Power Supply (V) | 230-400 | 24 | 24 | - | 24 | 230-400 | 230-400 |
| Maximum Pull (kg) | 2500 | 3000 | 3000 | 3000 | 4500 | 5000 | 5000 |
| Working load (kg) | 550 | 600 | 600 | 650 | 850 | 850 | 1200 |
| Amps at Working Load (A) | - | 210 | 210 | - | 215 | - | - |
| Line Speed at Working Load (m/min) | 16 | 14 | 14 | 17 | 10 | 10 | 11 |
| Max Line Speed (m/min) | 16 | 27 | 27 | 17 | 15 | 10 | 11 |
| Net Weight with Drum (kg) | 75 | 75 | 75 | 40 | 120 | 120 | 105 |
| Hydraulic Pressure (bar) | - | - | - | 200 | - | - | 200 |
| Hydraulic Flow (lt/min) | - | - | - | 32 | - | - | 40 |
| Control Box | Switchboard available separately | Included in package | Switchboard available separately | - | Included in package | Switchboard available separately | |

Alle CAPSTAN Modelle bitte einzeln bei uns anfragen.

Dimensions in mm

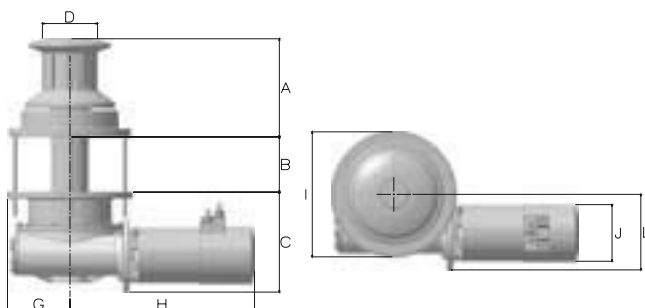

| Model | A | B | C | D | G | H | I | J | L |
|-------|-----|-------|-----|------|-----|-----|------|------|-----|
| T3000 | 206 | 60-90 | 190 | Ø150 | 142 | 436 | Ø255 | Ø152 | 190 |
| T4000 | 267 | 150 | 272 | Ø150 | 170 | 502 | Ø340 | Ø154 | 206 |

THE ORIGINAL WINDLASS



CETO - Recovery Capstan

The new CETO model is a unit built for the professional fishermen used for retrieving clam fishing baskets.

They are assembled using a heavy duty electric motor and gearbox, with the motor contained in an IP67 rated cover to be protected from humidity and sea water, and by a strong aluminum drum able to contain approximately 20 meters of fine rope.

They are available at a power rating of 1000W at 12V or 24V.

The drum is driven by use of a high torque worm gear box with the gear case made in black anodized marine aluminum. The gears are made of special bronze and steel in order to withstand the high stress during the intensive use of such an operation.

The top part is made by a simple construction of a anodized marine aluminum for the base and drum, and a stainless steel AISI 431 shaft.



IP67 rated heavy duty electric motor

Optional Accessories



| Construction | Marine anodised aluminum |
|---------------------------------------|--------------------------|
| Motor size | 1000 W |
| Power Supply (V) | 12V |
| Maximum Pull (kg) | 850 |
| Working load (kg) | 175 |
| Amps at Working Load (A) | 165 |
| Line Speed at Working Load (m/min) | 15 |
| Max Line Speed (m/min) | 15 |
| Net Weight with Drum (kg) | 16 |
| Circuit Breaker (available separatly) | L187333 |
| Control Box | Included in package |
| Code | L635999 |

Dimensions in mm

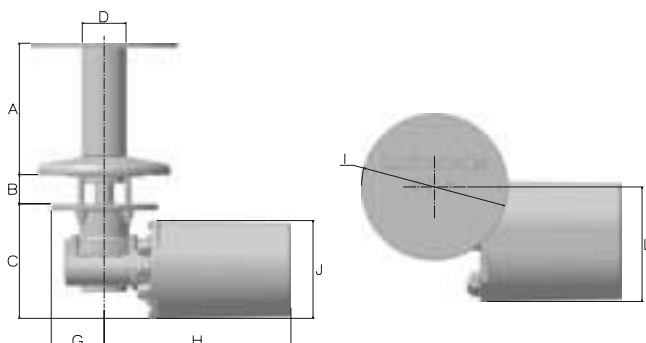

| Model | A | B | C | D | G | H | I | J | L |
|-------|-----|-------|-----|-----|------|-----|------|-----|-----|
| CETO | 180 | 25-40 | 150 | Ø60 | 72,5 | 256 | Ø200 | 134 | 157 |

www.lofrans.com

TENDER WINCH - Recovery Capstan



The Tender Winch models are units designed to recover a small tender or a jet ski. They are assembled using a heavy duty electric motor and gearbox, with the motor contained in an IP67 rated cover to be protected from humidity and sea water, and by a strong aluminum drum able to contain the necessary belt.

They are available at a power rating of 700W at 12V or 24V.

The drum is driven by use of a high torque worm gear box with the gear case made in black anodized marine aluminum. The gears are made of special bronze and steel in order to withstand the high stress during operation.

The top part is made by a simple construction of anodized marine aluminum for the base and drum, and a stainless steel AISI 43 1 shaft.

| Construction | Marine anodised aluminum | | |
|---------------------------------------|--------------------------|---------|---------|
| | 500W | 700 W | 700 W |
| Motor size | 500W | 700 W | 700 W |
| Power Supply (V) | 12V | 12V | 24V |
| Maximum Pull (kg) | 400 | 550 | 600 |
| Working load (kg) | 90 | 125 | 125 |
| Amps at Working Load (A) | 120 | 150 | 80 |
| Line Speed at Working Load (m/min) | 17 | 15 | 15 |
| Max Line Speed (m/min) | 20 | 20 | 20 |
| Net Weight with Drum (kg) | 9 | 9 | 9 |
| Circuit Breaker (available separatly) | L187331 | L187332 | L187331 |
| Control Box | Included in package | | |
| Code | L030054 | L602122 | L602123 |

Optional Accessories



Dimensions in mm

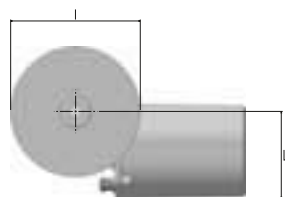
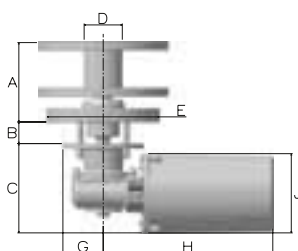

| Model | A | B | C | D | E | G | H | I | J | L |
|-------|-----|-------|-----|-----|------|----|-----|------|-----|-----|
| 500W | 96 | 18-30 | 124 | Ø40 | Ø114 | 56 | 236 | Ø145 | 110 | 121 |
| 700W | 110 | 18-30 | 124 | Ø53 | Ø156 | 56 | 236 | Ø180 | 110 | 121 |

THE ORIGINAL WINDLASS



CHAIN

STOPPER

The **chain stopper** is installed between the windlass and the bow roller in order to take the load off the windlass, either when the yacht is anchored or tensioning the anchor chain when the anchor is stowed. Windlasses which have two gypsies or a gypsy and a drum, need the chain stopper in order to isolate the one gypsy and either work with the other gypsy or with the drum.

LOFRANS' Chain stopper, stainless steel, for normal chain 12/ 13/ 14mm



Code...L72191

Chain stopper 14-16mm Stud link

- Chain stopper is designed to be used with chain size 14mm or 16mm stud link chain and 16mm normal chain.
- This model provides an increased safety by holding and blocking the chain and the anchor at the same time.
- AISI 316L Stainless steel
- Integrated devils claw for taking up the chain tension off the windlass.

Chain stopper 12-13-14 mm normal chain

- Chain stopper is designed to be used with chain size 12- 13- 14mm normal chain.
- This model provides an increased safety by blocking the anchor chain.
- AISI 316L Stainless steel

LOFRANS' Chain roller-stopper with tensioner, stainless steel, for chain 14/ 16mm



for studlink chain 14/ 16mm

Code...L72192

for normal chain 14/ 16mm

Code...L72193

| Model | L72191 | L72192 | L72193 |
|---------------------------------------|--------|--------|--------|
| X1 - Vertical Windlass | | | |
| X2 & Project 1000 - Vertical Windlass | | | |
| X3 & Project 1500 - Vertical Windlass | √ | | |
| X3.5 - Vertical Windlass | √ | | |
| X4 & Project 2000 - Vertical Windlass | √ | | |
| X5 - Vertical Windlass | √ | | |
| Ercole Vertical - Vertical Windlass | √ | √ | √ |
| Royal - Horizontal Windlass | | | |
| Dorado - Horizontal Windlass | | | |
| Atlas - Horizontal Windlass | | | |
| Kobra - Horizontal Windlass | | | |
| Cayman - Horizontal Windlass | | | |
| Tigres - Horizontal Windlass | | | |
| Falkon - Horizontal Windlass | √ | | √ |
| Titan - Horizontal Windlass | √ | | √ |
| Ercole - Horizontal Windlass | √ | √ | √ |
| Super Ercole - Horizontal Windlass | √ | √ | √ |

* The chain line need to be parallel to the chain stopper

www.lofrans.com

ELECTRIC ACCESSORIES

The range of accessories consists of a large selection of products to control windlass operations. All products are designed and built to guarantee perfect and reliable operation in the marine environment. Lofrans! Accessories are manufactured to the highest quality for reliability and safety, conforming to EC regulations covering electromagnetic compatibility (89/336/CEE). They are tested by official organizations for compliance to regulations and are CE marked.

For a windlass to function properly you will need to install:

- The **control box** unit which is supplied as standard, is made up of two solenoids included in a watertight box with an IP56 rating. Connecting the remote control to the control box is easily done by simply plugging the wiring onto the control box
- The **circuit breaker**, which offers three functions:
 - Protection from short circuit
 - Protection of the electric motor from current overload
 - Voltage interruption when the anchor windlass needs to be switched off. The circuit breaker is installed on a panel and has an LED indicator.
- One or more electric controls which can be connected in parallel.



IRIS CHAIN COUNTER



Panel Chaincounter IRIS

This fly bridge chain counter IRIS is technologically advanced instrument with an elegant and ergonomic design makes it suitable for all type of boat cockpits. IRIS is supplied with an evolved microprocessor, with different operations allowing an optimum anchoring.

- Chain speed indicator / mooring length in meters or feet
- Voltage indicator
- Up alarm sensor
- Switch on button / Key tones adjustment
- High vision LCD display / Backlit display screen / Eight level of contrast
- Six language menu (IT, EN, FR, DE, ES, GR)
- Able to control free fall windlasses
- Parallel connection

| | |
|----------------------------------|-----------------------------|
| Best-Nr.: | L600017 |
| Command transmission | Wire |
| Number of button | 3 |
| Voltage | 12 - 24V _{dc} |
| Operative temperature | -10 : +60 |
| IP protection rated* | 67 |
| Max contacts amperage (A) | 2 |
| Weight (gr) | 500 |
| Dimension (mm) | 110x105x15 (5 flat version) |

* When installed

T H E O R I G I N A L W I N D L A S S



GALAXY 703

CHAIN COUNTER



GALAXY 503

CHAIN COUNTER



Radio Control Chaincounter GALAXY 703

Without cable ties, plug or panels and with load always perfect by rechargeable battery, the radio chain counter GALAXY 703 gives finally all the freedom of manoeuvres and the comfort of reading in the anchoring operations.

- Chain speed indicator / mooring length in meters or feet
- Voltage indicator
- Up alarm sensor
- Switch on button / Key tones adjustment
- High vision LCD display / Backlit display screen / Eight level of contrast
- Six language menu (IT, EN, FR, DE, ES, GR)
- Able to control free fall windlasses
- Parallel connection

Hand Held Remote Control Chaincounter GALAXY 503

This remote chain counter model GALAXY 503 has been specifically designed to give the full control in anchoring. It's a reliable and practical instrument, technologically advanced, specifically design for use in marine environments. The external casing, rated with IP66 and supplied with waterproof plug and socket rated IP67. The extending flexible cable (approximately 4 metres) gives the maximum freedom on board during anchoring manoeuvring. Provided with an evolved microprocessor that offers a series of advantages for full control of the anchoring.

- Chain speed indicator / mooring length in meters or feet
- Voltage indicator
- Up alarm sensor
- Switch on button / Key tones adjustment
- High vision LCD display / Backlit display screen / Eight level of contrast
- Six language menu (IT, EN, FR, DE, ES, GR)
- Able to control free fall windlasses
- Parallel connection

| | |
|----------------------------------|-------------------------|
| Best-Nr.: | LGALAXY703 |
| Command transmission | Remote |
| Number of button | 3 (Transmitter) |
| Voltage | 12 - 24Vdc (Receiver) |
| Operative temperature | -10 : +60 |
| IP protection rated* | 66 (Transmitter) |
| Max contacts amperage (A) | 2 (Receiver) |
| Weight (gr) | 480 |
| Dimension (mm) | 155x65x45 (Transmitter) |

| | |
|----------------------------------|----------------|
| Best-Nr.: | L600015 |
| Command transmission | Wire |
| Number of button | 3 |
| Voltage | 12 - 24Vdc |
| Operative temperature | -10 : +60 |
| IP protection rated* | 66 |
| Max contacts amperage (A) | 2 |
| Weight (gr) | 710 |
| Dimension (mm) | 155x65x45 |

www.lofrans.com



GALAXY 102

HAND HELD CONTROL

Radio Remote Control



Hand Held Control GALAXY 102

This hand held remote control model GALAXY 102 has an elegant and functional design. The soft rubber case, which covers sideways the remote control, allows a safe and handy taking under any condition.

This hand held remote control is rated with IP66 and supplied with waterproof plug and socket rated IP67. The extending flexible cable (approximately 4 metres) gives the maximum freedom on board during anchoring manoeuvring.

- Inversion polarity protection
- Parallel connection
- 2 buttons (up-down)

Lofrans' radio remote control is designed to work with our range of windlasses. The remote control can also be used to operate other onboard equipment such as thrusters, passerelles, cranes, etc.

- Transmitter rated IP67
- Supports up to 8 independently controlled channels
- Each receiver can switch 4 channels (12/24 V - 2 A)
- Each transmitter can handle 2 receivers (8 channels)
- Digital recognition avoids accidental activation of other system
- Zero power consumption when in standby mode (transmitter)
- Easy to install and set up, simple to use

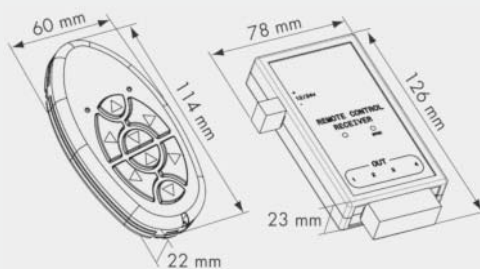

| | |
|---------------------------|------------------------|
| Best-Nr.: | LGALAXY102 |
| Command transmission | Wire |
| Number of button | 2 |
| Voltage | 12 - 24V _{dc} |
| Operative temperature | -10 : +60 |
| IP protection rated | 66 |
| Max contacts amperage (A) | 2 |
| Weight (gr) | 580 |
| Dimension (mm) | 155x65x45 |

* When installed

| Best-Nr.: | L312976 | L312977 |
|---------------------------|--|------------------------------|
| Description | Transmitter & Receiver (EU) | Transmitter & Receiver (USA) |
| Frequency | 868 MHz | 915 MHz |
| Number of button | 8 (Transmitter) | |
| Voltage | 12 - 24V _{dc} (Receiver) | |
| Operative temperature | -10 : +60 | |
| IP protection rated | 67 (Transmitter) | |
| Max contacts amperage (A) | 2 (Receiver) | |
| Weight (gr) | 310 | |
| Dimension (mm) | 114x60x22(transmitter) / 126x78x23(receiver) | |

** 868 MHz is the authorised frequency for Europe and Australia. 915 MHz is the authorised frequency for Canada and the USA. Retail sales and use of non-authorised frequency transmitters and receivers is prohibited. For all other countries please consult the local regulation in force.

THE ORIGINAL WINDLASS



Foot switch

This device is a switch which works simply pushing the foot on the button. The base is in stainless steel while the cover to prevent accidental engagement is in composite. The button is in special marine rubber able to withstand UV ray and the marine environment. Available in UP and DOWN version



| | | | |
|---------------------------|-----------------|-----------------|------------------|
| Best-Nr.: | LN0000CPE | LR0000CEP | L602121 |
| Description | Black / Grey UP | Red / Grey DOWN | Blue / WASH DOWN |
| Voltage | 12 - 24Vdc | | |
| Operative temperature | -10 : +60 | | |
| IP protection rated | 67 | | |
| Max contacts amperage (A) | 5 | | |
| Weight (gr) | 100 | | |
| Dimension (mm) | 80x95x20 | | |



Control Switch

TYPE "L"

This switch, usually installed on the cockpit, is made by a fixing plaque and by a three position switch (Up-Off-Down).

Best-Nr.: LL00000CP



TYPE "C"

This rocker switch has a modern and practical design. It is reliable and watertight and it is supplied with the apposite case to make simple and sure the installation.

Best-Nr.: L187338

Circuit Breaker

The thermal circuit breaker is an essential component of the electric plant. It has three functions:

- protects from very dangerous short circuits
- protects the electric motor of the windlass
- interrupts tension to windlass when desired

In case of short circuit the intervention is immediate. Concerning the electric motor a specific intervention curve has been studied in cooperation with E-T-A Germany. It is possible to re-activate the circuit breaker at the end of the intervention. The thermal circuit breaker is supplied with an elegant plaque for fixing and a led light. This unit is in compliance with EEC regulations and homologated by Bureau, Veritas.



| | | | | | | |
|-----------|-----------|---------|-----------|---------|-----------|-----------|
| | 35 A | 40 A | 70 A | 80 A | 100 A | 125 A |
| Thermal | LTR035ETA | - | LTR070ETA | - | LTR100ETA | LTR125ETA |
| Hydraulic | - | L600029 | - | L630616 | L600028 | - |

www.lofrans.com



Control Box Direction Solenoids

The Control Box is an electric unit made up of two remote control switches enclosed inside a special container which protects it from marine corrosion. The entire unit has been designed with a view to simplifying and speeding up the various electrical connections. For this purpose there is no need to open and/or pierce the container, as all the terminals and the panel for the electrical connections are perfectly accessible from the outside. Outer construction in self-extinguishing polyester resin, resistant to shock and marine corrosion. Degree of protection IP 56 - protection against deckwater.



| Best-Nr.: | LCB3M1712 | LCB3M1724 | L600020 | L602590 | LCB4M1712 | LCB4M1724 | L602587 |
|---------------------|------------|------------|-------------|-----------|-------------|------------|---------|
| Number of terminals | 3 | 3 | 3 | 4 | 4 | 4 | 4 |
| Power | 12 V | 24 V | 24 V | 12 V | 12 V | 24 V | 24 V |
| Motor Size | 500-1700 W | 500-1700 W | 1700-2300 W | 500-700 W | 1000-1700 W | 500-1700 W | 3500 W |

Wiring diagrams dependings on configuration and number of terminals

WIRING DIAGRAM - 2 TERMINALS ELECTRIC MOTOR

Control Box Code: 600021 - 600022

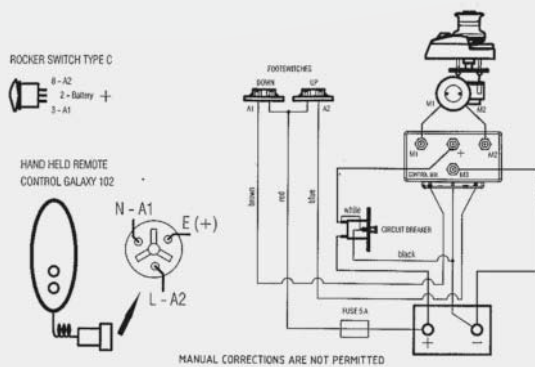

WIRING DIAGRAM - 3 TERMINALS ELECTRIC MOTOR

Control Box Code: 600018 - 600019 - 600020

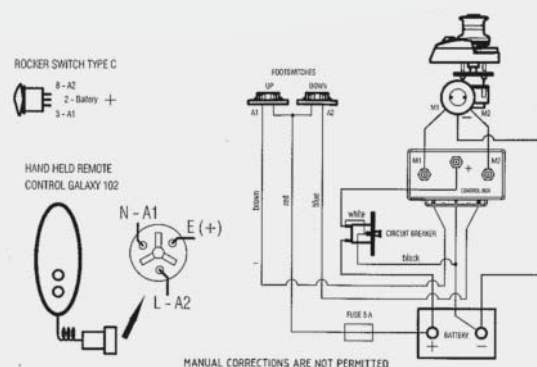

WIRING DIAGRAM - 4 TERMINALS ELECTRIC MOTOR

Control Box Code: 600021 - 600022

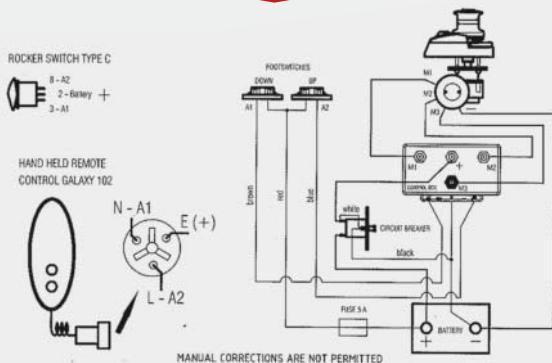

Schaltrelais mit mechanischer Bedienung durch Fußtaster in der Kappenfarbe Rot oder Schwarz

Best.-Nr. 570233800NE für Schaltrelais 2000W, 12V SCHWARZ,
570233800RO für Schaltrelais 2000W, 12V ROT

THE ORIGINAL WINDLASS



Kits for big Models & Capstans

| KIT A - SEALS | | KIT B - SCREWS | | KIT C - PINS | | KIT D - CIRCLIPS | |
|---------------|-------------------|----------------|-------------------|--------------|-------------------|------------------|-------------------|
| Best-Nr.: | For WINDLASS | Best-Nr.: | For WINDLASS | Best-Nr.: | For WINDLASS | Best-Nr.: | For WINDLASS |
| L474013 | X4 & PROJECT 2000 | L474012 | X4 & PROJECT 2000 | L474011 | X4 & PROJECT 2000 | L474010 | X4 & PROJECT 2000 |
| L418428 | ERCOLE VERTICAL | L418475 | ERCOLE VERTICAL | L418499 | ERCOLE VERTICAL | L418556 | ERCOLE VERTICAL |
| L418403 | TITAN | L418457 | TITAN | L418493 | TITAN | L418553 | TITAN |
| L418423 | ERCOLE | L418472 | ERCOLE | L418494 | ERCOLE | L418555 | ERCOLE |
| L427806 | SUPER ERCOLE | L418476 | SUPER ERCOLE | L418500 | SUPER ERCOLE | L418575 | SUPER ERCOLE |
| L418410 | T500 | L418446 | T500 | L418483 | T500 | L418512 | T500 |
| L418411 | T700 - T1000 | L418410 | X0 & T500 | L418487 | T1500 - T1700 | L418513 | T700 - T1000 |
| L418422 | T1500 - T1700 | | | | | L418514 | T1500 - T1700 |
| L418399 | T2000 - T2500 | | | | | L418515 | T2000 - T2500 |

| KIT F - FINGERS | | KIT S - MAGNETIC SENSORS | |
|-----------------|-----------------------|--------------------------|-------------------------------|
| Best-Nr.: | For WINDLASS | Best-Nr.: | For WINDLASS |
| L474023 | X1, X2 & PROJECT 1000 | L474053 | X1, X2 & X3 |
| L474017 | X3 & PROJECT 1500 | L600033 | X4 |
| L601047 | X2 | L474048 | for all horizontal windlasses |
| L602105 | X3 | | |
| L35036 | DORADO | | |
| L632116 | ATLAS | | |

Maintenance Kit

KEEP YOUR LOFRANS' AS GOOD AS NEW!

| Best-Nr.: | For WINDLASS |
|-----------|---------------------------|
| L72036 | X0 |
| L72037 | X1 |
| L72038 | X2 & PROJECT 1000 |
| L72039 | X2 ALU |
| L72040 | X3, X3 ALU & PROJECT 1500 |
| L72046 | ROYAL |
| L72047 | DORADO |
| L72048 | KOBRA & CAYMAN |
| L72050 | TIGRES |
| L72051 | FALKON |
| L72045 | ATLAS |



Exploded diagram ►

Please refer to our website for Kit Contents

www.lofrans.com

HANDFERNBEDIENUNG

Diese Handfernbedienungen mit Spiralkabel (etwa 2,5 bis 3 Meter ausziehbar) eignen sich zum Bedienen von Ankerwinden, Winschen und Bugschrauben. Angeschlossen werden diese an ein entsprechend Ihres Motors ausgelegtes Doppelrelais, das jedoch nicht zum Lieferumfang der Handfernbedienung gehört.

Alle Handfernbedienungen werden von MZ electronic mit Stecker, Steckdose und Spiralkabel ausgeliefert.

Das Modell EV 200 verfügt über zwei Tasten (Heben und Senken), das Modell EV 300 über drei Tasten (Ein-Aus-Schalter, sowie Heben und Senken) und das Modell EV 400 über vier Taster für Ansteuerungen, wie Heben und Senken und Links Rechts.

Die Masse sind ca.: 145mm X 50mm X 22mm

Die Modelle NAUTI 600 verfügen über 6 Funktionstasten, das NAUTI800 Modell über 8 Funktionstasten.

Die Masse bei NAUTI sind ca.: 145mm X 60mm X 22mm

| Typ / Modell | Best.-Nr. |
|--------------|------------|
| EV 200 | 49EV200 |
| EV300 | 49EV300 |
| EV400 | 49EV400 |
| NAUTI600 | 49NAUTI600 |
| NAUTI800 | 49NAUTI800 |



EV200



EV300



NAUTI800



EV400

FERNBEDIENUNG MIT KETTENZÄHLWERK

Diese Handfernbedienung EV020 mit Spiralkabel (etwa 2,5 bis 3 Meter ausziehbar) eignet sich zum Bedienen von Ankerwinden und kann über einen Sensor (nicht im Lieferumfang enthalten) den Zählerstand Ihrer Ankerkette anzeigen. Alle Handfernbedienungen werden von MZ electronic mit Stecker, Steckdose und Spiralkabel ausgeliefert.

Das Modell EV 020 verfügt über drei Tasten (Ein-Aus-Schalter, sowie Heben und Senken) und ein Anzeigedisplays, das durch eine aufklappbare Klappe geschützt ist.

Das Zubehörkit umfasst einen separat bei der Kettennuss zu installierenden Sensor und Magneten, sowie Kabel zum Anschluß an einer entsprechenden Relaisbox (die Relaisbox gehört nicht zum Lieferumfang!). Einige Modelle von Lofrans' haben diesen Sensor bereits ab Werk vorinstalliert und daher wird dieses Kit nur als Zubehör angeboten, falls Ihre Winde dies nicht vorgerüstet hat.

Die Masse sind ca.: 145mm X 50mm X 22mm

| Typ / Modell | Best.-Nr. |
|--------------|------------|
| EV 020 | 49EV020 |
| Zubehörkit | 49NAUTI001 |

EV020



Weitere Ersatzteile, **passend für Lofrans' und MZ!**

BESCHREIBUNG

- a) Stecker 3 polig, Original Bulgin
- b) Steckdose Aufbau 3 polig, Original Bulgin
- b) Stecker Einbau 3 polig, Original Bulgin
- a) Stecker 6 polig, Original Bulgin
- b) Steckdose Aufbau 6 polig, Original Bulgin
- b) Stecker Einbau 6 polig, Original Bulgin

- Best.-Nr.
- 50PX0731/P
- 50PX0756/S
- 50PX0765/S
- 50PX0739/P
- 50PX0758/S
- 50PX0767/S

- Abdeckkappe für Bulgin Steckdosen (Innengewinde) 50PX0733
- Abdeckkappe für Bulgin Stecker (Außengewinde) 50PX0734



EV040

FUNKFERNBEDIENUNG MIT KETTENZÄHLWERK

Diese Fernbedienung EV040 mit Funkübertragung der Signale eignet sich zum Bedienen von Ankerwinden und kann über einen Sensor (nicht im Lieferumfang enthalten) den Zählerstand Ihrer Ankerkette anzeigen. Dieses Modell von MZ electronic wird über das mitgelieferte Zigarettenanzünder-Ladekabel wieder aufgeladen.

Diese Deluxe Version verfügt über 5 Sprachmöglichkeiten im Anzeigemodus und im Display wird auch der Ladezustand des Akkus angezeigt. Mehrere Menüpunkte sind individuell einzustellen, damit je nach Kettennussgröße bzw. Kettengröße auch die Anzeige korrekt ist.

Im Lieferumfang enthalten sind ein Handsender und eine Empfängereinheit in einer Box (ähnlich der Abbildung).

Bitte beachten Sie, dass zum Betrieb ein Doppelrelais vorhanden sein muss, die das Steuersignal über die Empfängereinheit dorthin überträgt. Dieses Doppelrelais ist nicht im Lieferumfang enthalten!

Das Modell EV 040 verfügt über drei Tasten (Ein-Aus-Schalter, sowie Heben und Senken) und ein Anzeigedisplay, das durch eine aufklappbare Klappe geschützt ist.

Das Zubehörkit umfasst einen separat bei der Kettennuss zu installierenden Sensor und Magneten, sowie Kabel zum Anschluß an der Empfängerboxeinheit (diese gehört nicht zum Lieferumfang des Zubehörkits). Einige Modelle von Lofrans' haben diesen Sensor bereits ab Werk vorinstalliert und daher wird dieses Kit nur als Zubehör angeboten, falls Ihre Winde dies nicht vorgerüstet hat.

Die Masse sind ca.: 145mm X 50mm X 22mm

| Typ / Modell | Best.-Nr. |
|--------------|-----------|
| EV 040 | 49EV040 |
| Zubehörkit | 49NAUT001 |

EV030

FERNBEDIENUNG MIT KETTENZÄHLWERK ZUM FESTEINBAU MIT KABEL ODER PER FUNKFERNBEDIENUNG

Diese Fernbedienung EV030 mit Kabelanschluss und EV030Radio mit Funkverbindung eignen sich zum Bedienen von Ankerwinden und zeigt über einen Sensor (nicht im Lieferumfang enthalten) den Zählerstand Ihrer Ankerkette an.

Diese Modelle verfügt über drei Tasten (Ein-Aus-Schalter, sowie Heben und Senken) und ein Anzeigedisplay.

Das Zubehörkit umfasst einen separat bei der Kettennuss zu installierenden Sensor und Magneten, sowie Kabel zum Anschluß an einer entsprechenden Relaisbox (die Relaisbox gehört nicht zum Lieferumfang!). Einige Modelle von Lofrans' haben diesen Sensor bereits ab Werk vorinstalliert und daher wird dieses Kit nur als Zubehör angeboten, falls Ihre Winde dies nicht vorgerüstet hat.

Die Masse sind ca.: 100mm X 100mm X 32mm

| Typ / Modell | Best.-Nr. |
|--------------|--------------|
| EV 030 | 49EV030 |
| EV 030 Radio | 49EV030Radio |
| Zubehörkit | 49NAUT001 |

KOMPASS 4
KOMPASS 2

FERNBEDIENUNG MIT 2 BZW. 4 KANÄLEN

MZ electronic bietet ferner Fernbedienung mit Funkübertragung der Signale zum Bedienen von Ankerwinden, Winschen oder Bugschrauben an. Dies als Zweikanal (Heben und Senken) oder Vierkanalversion mit Hebe- und Senk-, sowie Links- und Rechts-Taster, sowie einem Ein- und Ausschalttaster. Im Lieferumfang enthalten sind ein Handsender und eine Empfängereinheit in einer Box.

Bitte beachten Sie, dass zum Betrieb ein Doppelrelais vorhanden sein muss, die das Steuersignal über die Empfängereinheit dorthin überträgt. Dieses Doppelrelais ist nicht im Lieferumfang enthalten!

Der Handsender ist kompakt gebaut, sendet auf der Frequenz 433,92 Mhz und ist nicht wasserdicht!

| Typ / Modell | Best.-Nr. |
|--------------|-------------|
| KOMPASS-2 | 49KOMPASS-2 |
| KOMPASS-4 | 49KOMPASS-4 |

Original Kettennüsse GYPSIES



| Best-Nr.: | Chain Size | For windlass |
|-----------|---|--|
| L630953 | | X2 / PROJECT 1000 |
| L630968 | 6 mm ISO 4565 / DIN 766 | KOBRA / CAYMAN / TIGRES / ROYAL / AIRON |
| L630970 | | X0 / X1 / X1 ALU |
| L630974 | | DORADO |
| L631005 | | ATLAS |
| L630978 | 7 mm ISO 4565 | KOBRA / CAYMAN / TIGRES / ROYAL / AIRON |
| L630980 | | X1 / X1ALU |
| L630984 | | DORADO |
| L631007 | | ATLAS |
| L630949 | 8 mm ISO 4565 / DIN 766 | X2 / PROJECT 1000 |
| L630957 | | X3 / PROJECT 1500 |
| L630994 | | KOBRA / CAYMAN / TIGRES / ROYAL / AIRON |
| L630996 | | FALKON / TITAN / PROJECT 2000 / X4 / X3.5 |
| L630999 | | X1 |
| L631003 | | DORADO |
| L631009 | | ATLAS |
| L630951 | | X2 / PROJECT 1000 |
| L630959 | X3 / PROJECT 1500 | |
| L631011 | 10 mm ISO 4565 | KOBRA / CAYMAN / TIGRES / ROYAL / AIRON |
| L631013 | | FALKON / TITAN |
| L631019 | | ERCOLE (Horizontal & Vertical) / SUPER ERCOLE |
| L631022 | | FALKON / TITAN / PROJECT 2000 / X4 / X3.5 |
| L630955 | 10 mm DIN766 | X2 / PROJECT 1000 |
| L630966 | | X3 / PROJECT 1500 |
| L631132 | | FALKON / TITAN / PROJECT 2000 / X4 / X3.5 |
| L631118 | | KOBRA / CAYMAN / TIGRES / ROYAL / AIRON |
| L630961 | | X3 / PROJECT 1500 |
| L631039 | | ERCOLE (Horizontal & Vertical) / X5 |
| L631031 | FALKON / TITAN / PROJECT 2000 / X4 / X3.5 | |
| L631045 | 12 mm ISO 4565 13 mm DIN 766 | X3.5 |
| L631050 | 13 mm DIN 764 | FALKON |
| L631085 | | ERCOLE (Horizontal & Vertical) / SUPER ERCOLE / X5 |
| L631065 | 14 mm | ERCOLE (Horizontal & Vertical) / SUPER ERCOLE / X5 |
| L631059 | | FALKON / TITAN / PROJECT 2000 / X4 / X3.5 |
| L631088 | 16 mm DIN766 | ERCOLE (Horizontal & Vertical) / SUPER ERCOLE |
| L631082 | 16 mm | ERCOLE (Horizontal & Vertical) / SUPER ERCOLE |
| L631095 | 18 mm DIN766 | ERCOLE (Horizontal & Vertical) / SUPER ERCOLE |
| L631101 | 18 mm | ERCOLE (Horizontal & Vertical) / SUPER ERCOLE |
| L631113 | 20 mm | ERCOLE (Horizontal & Vertical) / SUPER ERCOLE |
| L631033 | 1/2" BBB | FALKON / TITAN / PROJECT 2000 / X4 / X3.5 |
| L631120 | 3/8" BBB | KOBRA / CAYMAN / TIGRES / ROYAL / AIRON |
| L631036 | 1/2" G40 | FALKON / TITAN / PROJECT 2000 / X4 / X3.5 |
| L631124 | 3/8" G40 | FALKON / TITAN |
| L631077 | 5/16" HT | KOBRA / CAYMAN / TIGRES / ROYAL / AIRON |
| L631129 | | FALKON |
| L630992 | 7/16" HT | FALKON |
| L631122 | 3/8" PC | KOBRA / CAYMAN / TIGRES / ROYAL / AIRON |
| L631056 | 13 ITALMET | ERCOLE (Horizontal & Vertical) / SUPER ERCOLE |
| L631062 | 14 PITCH 42mm | TITAN |
| L630989 | 14.5 UNI4417 | ERCOLE VERTICAL |
| L631053 | 1/2" STUDLINK | ERCOLE (Horizontal & Vertical) / SUPER ERCOLE |
| L631068 | 14 STUDLINK | ERCOLE (Horizontal & Vertical) / SUPER ERCOLE |
| L631092 | 16 STUDLINK | ERCOLE (Horizontal & Vertical) / SUPER ERCOLE |
| L631098 | 17.5 STUDLINK | ERCOLE (Horizontal & Vertical) / SUPER ERCOLE |
| L631104 | 19 STUDLINK | ERCOLE (Horizontal & Vertical) / SUPER ERCOLE |
| L631110 | 20 STUDLINK | ERCOLE (Horizontal) / SUPER ERCOLE |

CHAINS SECTION

| CHAIN d | Inside Length L (mm) | Outside Width w (mm) |
|-------------------|----------------------|----------------------|
| 6 ISO | 18 | 20 |
| 7 ISO | 21 | 24 |
| 8 ISO | 24 | 27 |
| 10 ISO | 30 | 34 |
| 12 ISO | 36 | 40 |
| 14 ISO | 42 | 47 |
| 6 DIN 766 | 18.5 | 20 |
| 7 1/4" DIN 766 | 22 | 23 |
| 8 - 5/16" DIN 766 | 24 | 26 |
| 10 - 3/8" DIN 766 | 28 | 34 |
| 13 - 1/2" DIN 766 | 36 | 44 |

| Best-Nr.: | Rope Size | For windlass |
|-----------|-----------|--------------|
| L634877 | 12-14mm | DORADO |

THE ORIGINAL WINDLASS



CUSTOMIZED SOLUTIONS



As part of the Lofrans' ability and capacity to deliver products for a wide range of vessels, the high end Mega Yacht demand for anchoring solutions could not be left unsupported.

Each yacht is considered as unique, as is the choice of anchoring equipment made by boat builders and naval architects around the world.

These products are almost always tailored to suit the individual requirements of yacht owners and operators, they are given special attention in all stages of their definition, design, manufacture, installation and commissioning.

A specific team of people, led by our Technical Manager, Mr. Luca Rivolta, focus on specific projects such as these, to be able propose products to yacht builders that exceed their needs in reliability, safety, look and engineering excellence.



In Lofrans', this has been our goal since 1966.

SELECTING THE WINDLASS

VERTICAL OR HORIZONTAL?

The space available on and under the deck is the main criteria to be considered when selecting a vertical or a horizontal windlass.

Vertical windlasses have main shaft rotation vertical to the deck and allowing a reduced use of space on deck while the electric motor and the gearbox are below deck, in the chain locker.

Horizontal windlasses are installed on deck and they have a rotation horizontal to the deck. They are recommended on vessels where there is a limitation to the chain locker space. The electric motor and the gearbox are protected by a cover and they are easily accessible for maintenance.

To help stowing of the chain in the chain locker and for better performance of the windlass, the distance between the top of the heaped chain and the under-deck must be at least 300 mm.

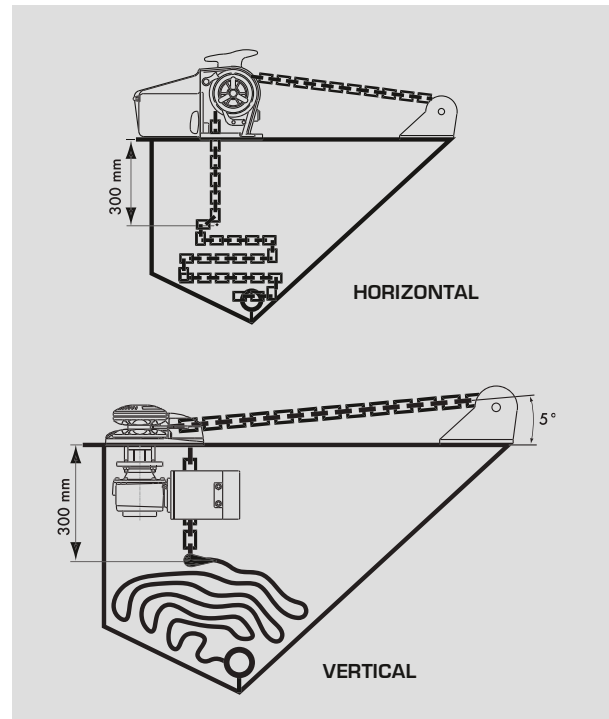

DC, AC OR HYDRAULIC?

The windlass can be supplied in three different ways of motorization: direct current, alternate current and hydraulic.

- D.C. motorization is the most popular for reliability. The maintenance is very limited and this kind of electric motor is used for vessels up to 90 feet of length.
- A.C. motorization is the choice for boats from 90 up to 120 feet of length which have generators on board. A.C. motors offer good torque; they need a simple installation and limited maintenance.
- Hydraulic motorization gives the advantage of supply a constant torque while the load changes. They are very popular on boats of over 120 feet length. They need a specific installation.

MAX PULL AND WORKING LOAD

Max pull is the maximum pull that the windlass is able to supply for a few seconds.

Working Load is a load which simulates the operating conditions.. This load is the reference for ampere drawing and the speed data indicated in the catalogue.

PROPER WINDLASS SELECTION

The steps to select a vertical or horizontal windlass are:

- Select the proper model checking the chart - windlass model length of the boat.
- Calculate the ground tackle which is made by anchor weight, total chain and rope weight on board.
- Ground tackle not to exceed the working load with a tolerance + 10%.

Eg sample on a boat of 42 feet

| 1. Calculation of the round tackle (anchor + rope + total chain) | | | | |
|---|--------|---------------------------------------|------------------|------------------|
| eg | Anchor | Chain 10 - 75mt - weight 2,2 kg/mt | Rope 25m/75ft | Ground tackle |
| | 25g | 165Kg | 5Kg | 190Kg |

CIRCUIT BREAKER

The circuit breaker protects the electric motor and the cables of the windlass from current overload. It is installed on the power line and it trips automatically when the current is over the rated use following a specific time/ current curve. It is essential install this device for safety reasons.

The circuit breaker once tripped can be engaged again.

Choosing the proper circuit breaker is very important. You have to select the delayed time/current curve as the anchor windlass ampere drawing changes following the variable load.

Lofrans' does not recognize warranty in case of improper proper circuit breaker being installed.

T H E O R I G I N A L W I N D L A S S



SAFETY

The windlass is designed to lift the ground tackle but it is not designed to take the load of the whole boat. For this reason we strongly recommend the use of a chain stopper in order to spread the load and avoid to damage from overload on the structural components of the windlass.

MANUAL OVERRIDE

Most of the Lofrans' windlasses are supplied with manual override which makes the windlass able to recover the chain in case of failure of the electrics.

The manual override is inserted inside the gearbox and consists of a spring loaded ratchet which has the secondary function to make a sort of mechanical safety feature, in order to prevent chain jams in the chain locker from damaging the deck.

CLUTCH

In the Lofrans' anchor windlasses, the main shaft and the gipsy are connected by a pair of conical discs called clutches. They are normally engaged by screwing the top or side, star shaped nut. To engage or disengage the clutch you have to insert the supplied handle in this nut.

By disengaging the clutch, the gipsy is free to rotate and the weight of the anchor releases the rode into the water.

AUTOMATIC FREE FALL

On some horizontal anchor windlasses there is an installed optional device called AUTOMATIC FREE FALL. This device allows the user to disengage the clutch automatically simply by pushing the DOWN button of the remote.

ROPE AND CHAIN MANAGEMENT

Most of the Lofrans anchor windlasses are able to manage rope and chain by a special spring load tension arm called finger which pushes the rope deeply inside the gipsy teeth.

Hydraulic Models - Dimensions in mm

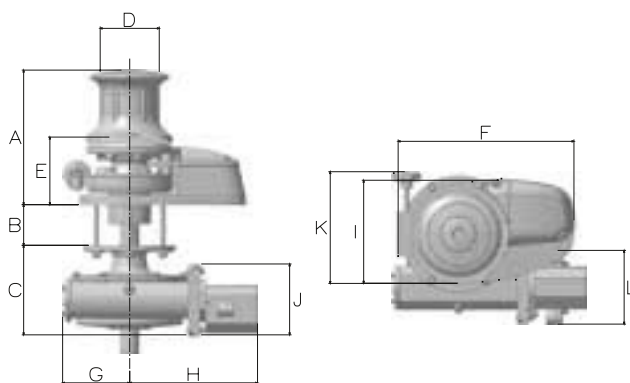

| X4 | A | B | C | D | E | F | G | H | I | J | K | L |
|---------------|-----|--------|-----|------|-----|-----|-----|-----|-----|-----|-----|-----|
| Hydraulic 8cc | 285 | 60-130 | 200 | Ø125 | 150 | 380 | 140 | 270 | 220 | 150 | 240 | 156 |

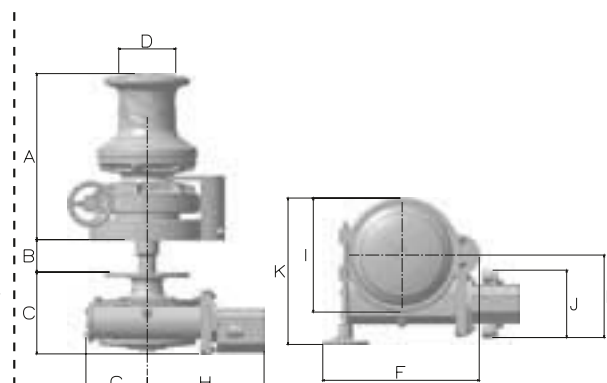

| X5 | A | B | C | D | F | G | H | I | J | K | L |
|---------------|-----|-------|-----|------|-----|-----|-----|-----|-----|-----|-----|
| Hydraulic 8cc | 385 | 60-90 | 190 | Ø132 | 365 | 142 | 270 | 264 | 156 | 339 | 190 |

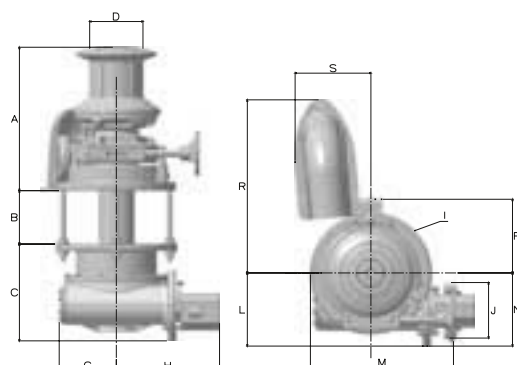

| Ercole Verticale | A | B | C | D | G | H | I | J | L | M | N | P | R | S |
|------------------|-----|-----|-----|-----|-----|-----|-----|-----|-----|-----|-----|-----|-------------------|-------------------|
| Hydraulic 11cc | 400 | 150 | 272 | 150 | 160 | 290 | 340 | 156 | 205 | 405 | 205 | 205 | min 490 - max 600 | min 200 - max 230 |

www.lofrans.com

www.lofrans.com



ADVISOR

Up-to-date technical information

PRODUCTS

Comprehensive product selection



Complete spare parts information

SPARE PART ORDERING IN 2 STEPS

easy spare part selection

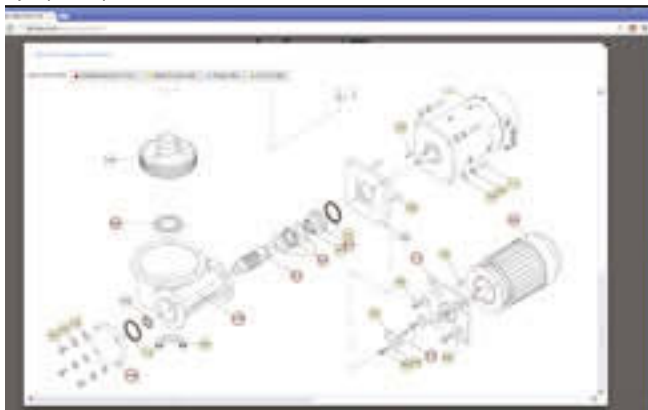
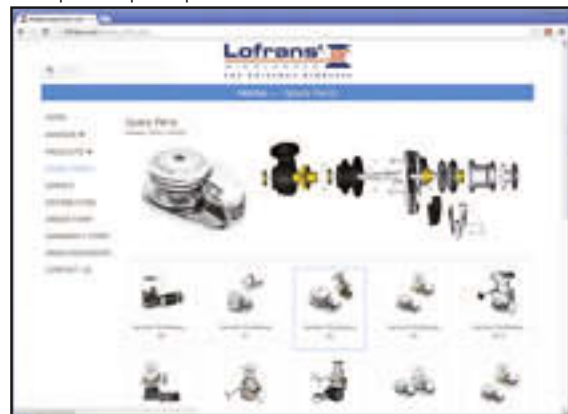

To order spare parts, all is needed is an internet connection

THE ORIGINAL WINDLASS



WARRANTY

Take advantage of the 3 year warranty period



GLOBAL NETWORK

Lofrans' international representation



www.lofrans.com

INTEGRATED HYDRAULIC SYSTEMS



As of 2013, a strong partnership has been built among Lofrans' and Max Power thrusters creating a synergy in yacht control and maneuvering solutions.

As a natural evolution from simple stand-alone independent units, Max Power is able to offer fully integrated hydraulic systems for sailing yachts. Whether running winches, windlasses, bow thrusters, stern thrusters, hydraulic davits or complex keel lifting mechanisms, our complete hydraulic solutions are used by many of the world's large sailing yacht manufacturers. Unique in their flexibility, Our systems are built using a common central line principle.



This means any function can be run from any power source thereby allowing a high level of user control. The use of load sensing pumps and valves ensures efficient and silent operation over a wide range of hydraulic flows and pressures. Our experience in designing and supplying complete solutions ensures that a Max Power-Lofrans' integrated system will be efficient, flexible and reliable.

Sailing yacht power systems typically include one or several generator mounted hydraulic pumps and in addition will require a DC power pack for silent sailing and light maneuvering. The PowerValve™ power pack range used in our systems, offers exceptional flexibility and power efficiency over a wide range of hydraulic flows.

Available as single or twin motor units, each motor pump can deliver 3 flow ratings at two predetermined system pressures, thereby accommodating a wide variety of hydraulic functions. From high pressure, low flow keel, to a powerful high flow windlass, each function only draws the amperage needed for that specific application.

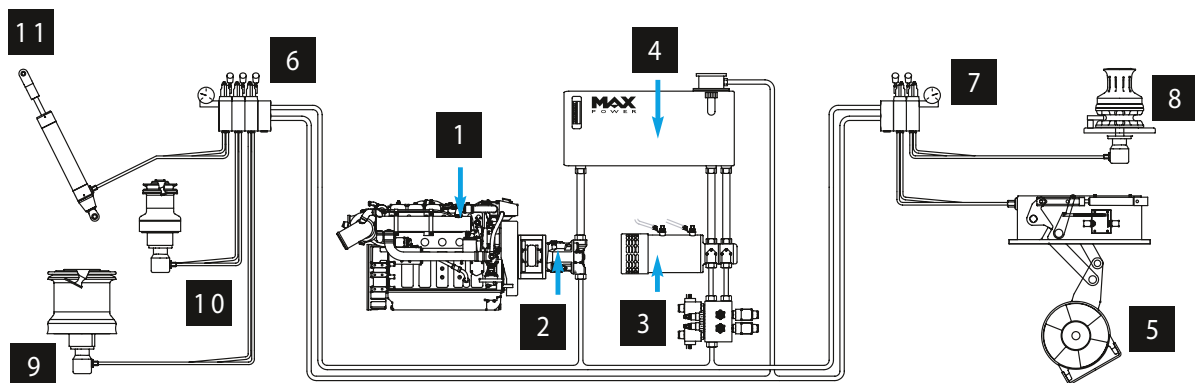

- | | |
|--------------------------------------|------------------|
| 1 Generator with PTO | 7 Control Valve |
| 2 Variable displacement pump | 8 Windlass |
| 3 DC power pack | 9 Winch |
| 4 Oil tank with filtration and gages | 10 Winch |
| 5 Thruster | 11 Hydraulic ram |
| 6 Control Valve | |

THE ORIGINAL WINDLASS